



Slider M35 Top
SALICE

Slider M35 Top



Slider M35 Top is a coplanar sliding system for medium sized cabinets, with doors width up to 1500 mm and a max. weight of 35 kg per door.

The M35 Top mechanism incorporates a sophisticated magnetic damping system that decelerates the opening and closing action and sets a new standard of silent and smooth sliding movement by eliminating the typical noise produced by spring- action dampers.

In its standard version, the M35 Top can be used to open two identical coplanar doors, or a single sliding door paired with a hinged door or an open compartment.

In addition to the standard version that opens two coplanar doors in the traditional way, the system is available in number of options that significantly increase the number of possible applications:

- Slider M35 Top Reverso that enables the doors to be opened in the opposite direction;
- Slider M35 Top Step that, with a single system, enables the doors to be opened when they are separated by a central compartment;
- Slider M35 Top One, a system for the opening of a single door;
- Slider M35 Top Power, a motorised system for opening the door.





Technical information

Coplanar sliding system for cabinets.

Door dimensions:

- max. weight per door 35 Kg
- width min. 600 mm max. 1500 mm
- height min. 1200 mm max. 1800 mm
- thickness: - min. 18 mm max. 30 mm
- with handle max. 40 mm
- material: wood

Adjustment:

- vertical adjustment ± 5 mm
- horizontal adjustment ± 3.5 mm
- front adjustment: - upper ± 3 mm
- lower ± 2 mm

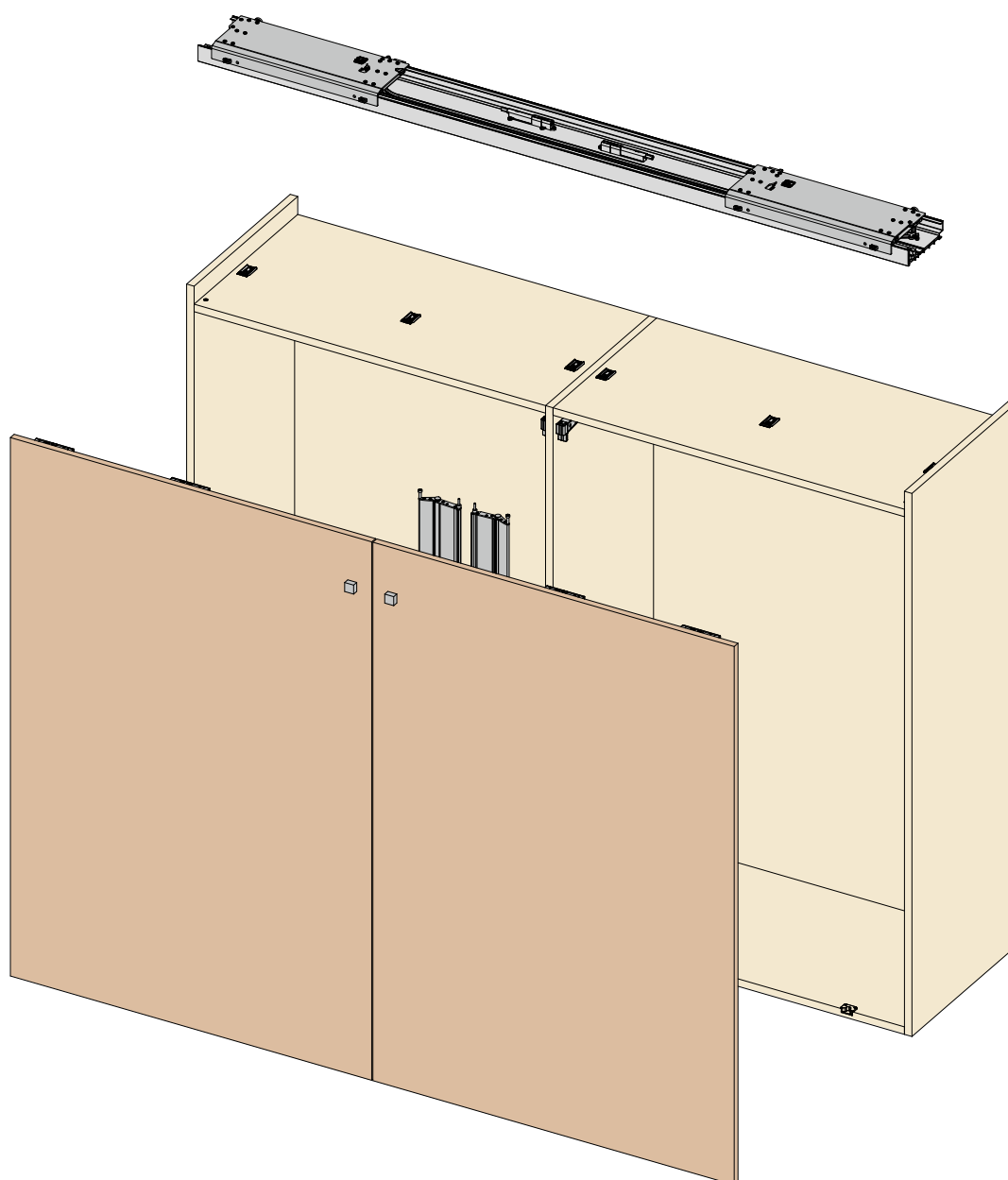

Components of the system

Horizontal supporting profile

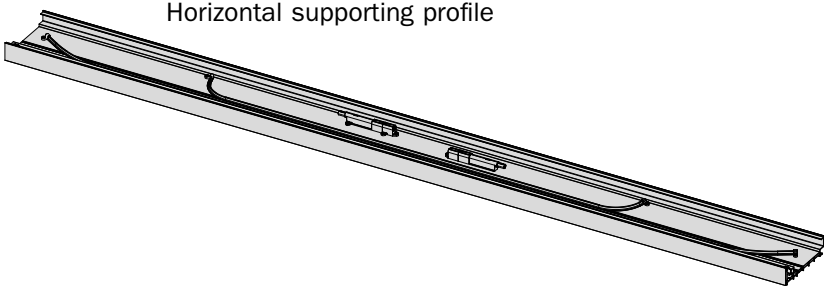

Transmission brackets



Sliding profile for door



Door adjusters

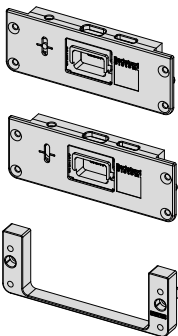

Plates for the rotation of the transmission bracket

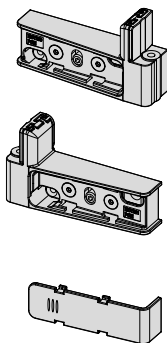

Runner stop for door and activator for the transmission bracket

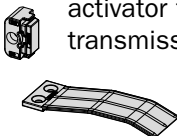

Fixing clip for sliding profile for door



Hardware

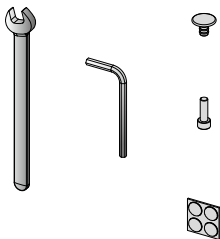

Fixing clip for horizontal supporting profile



Stabiliser and damper for left door

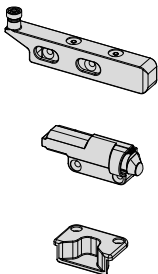

Stabiliser and damper for right door

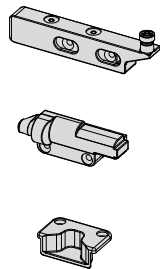

Recessed adjusters

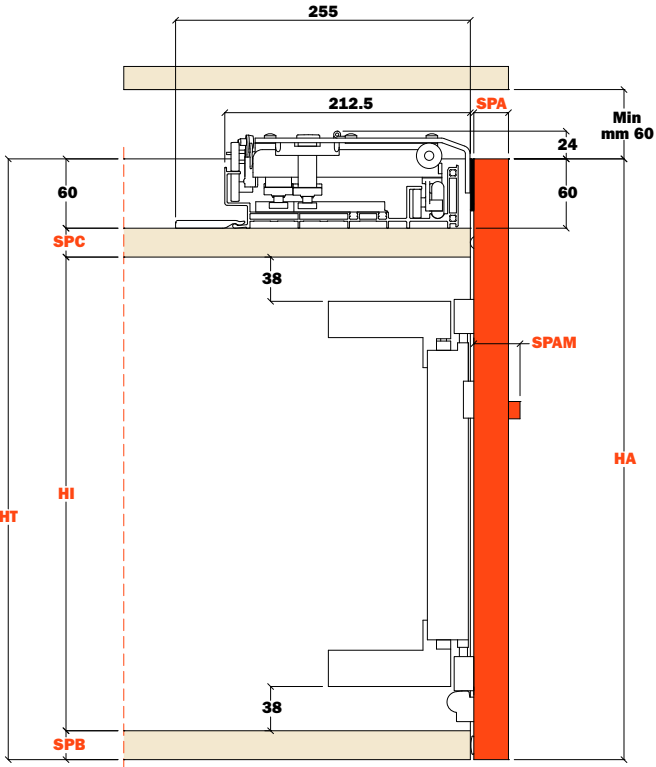

External adjusters

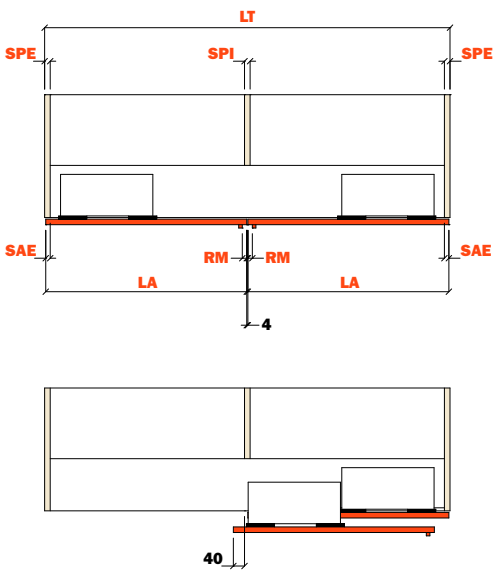
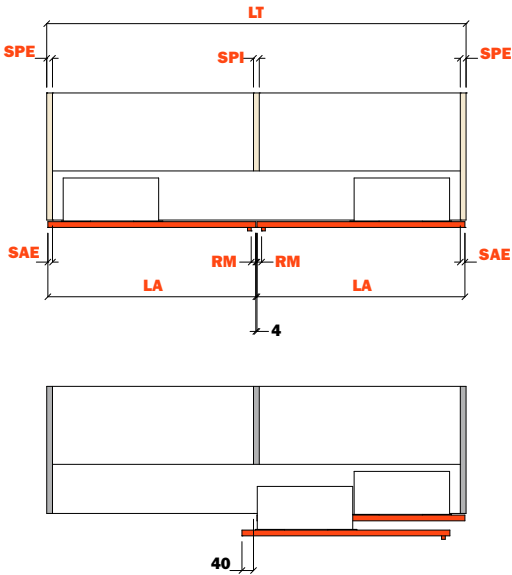
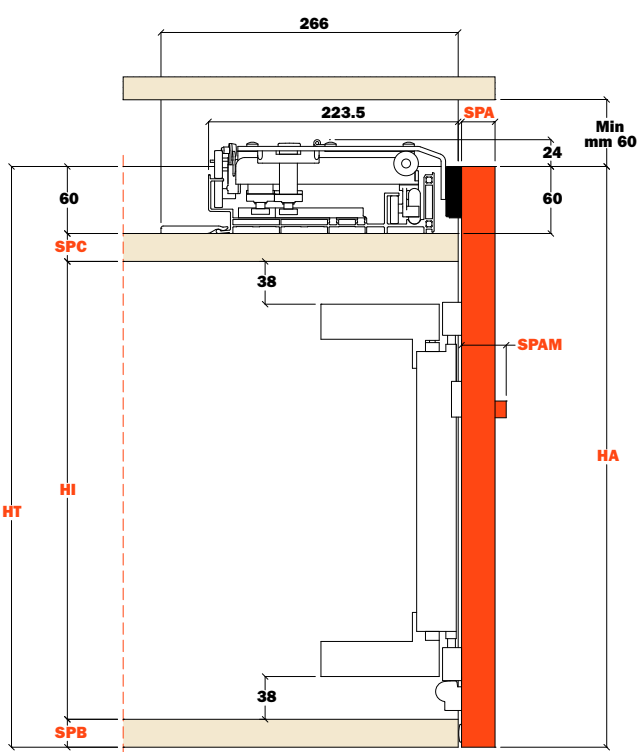

Relation between height and width

DOOR DIMENSION										
DOOR HEIGHT	1800 mm									
	1600 mm									
	1400 mm									
	1200 mm									
		600	700	800	900	1000	1200	1300	1400	1500
		WIDTH								

Assembly instructions

Fix the fixing dowels (1) for the safety screws.

Fix the clips for the horizontal supporting profile (2) with the screws provided.

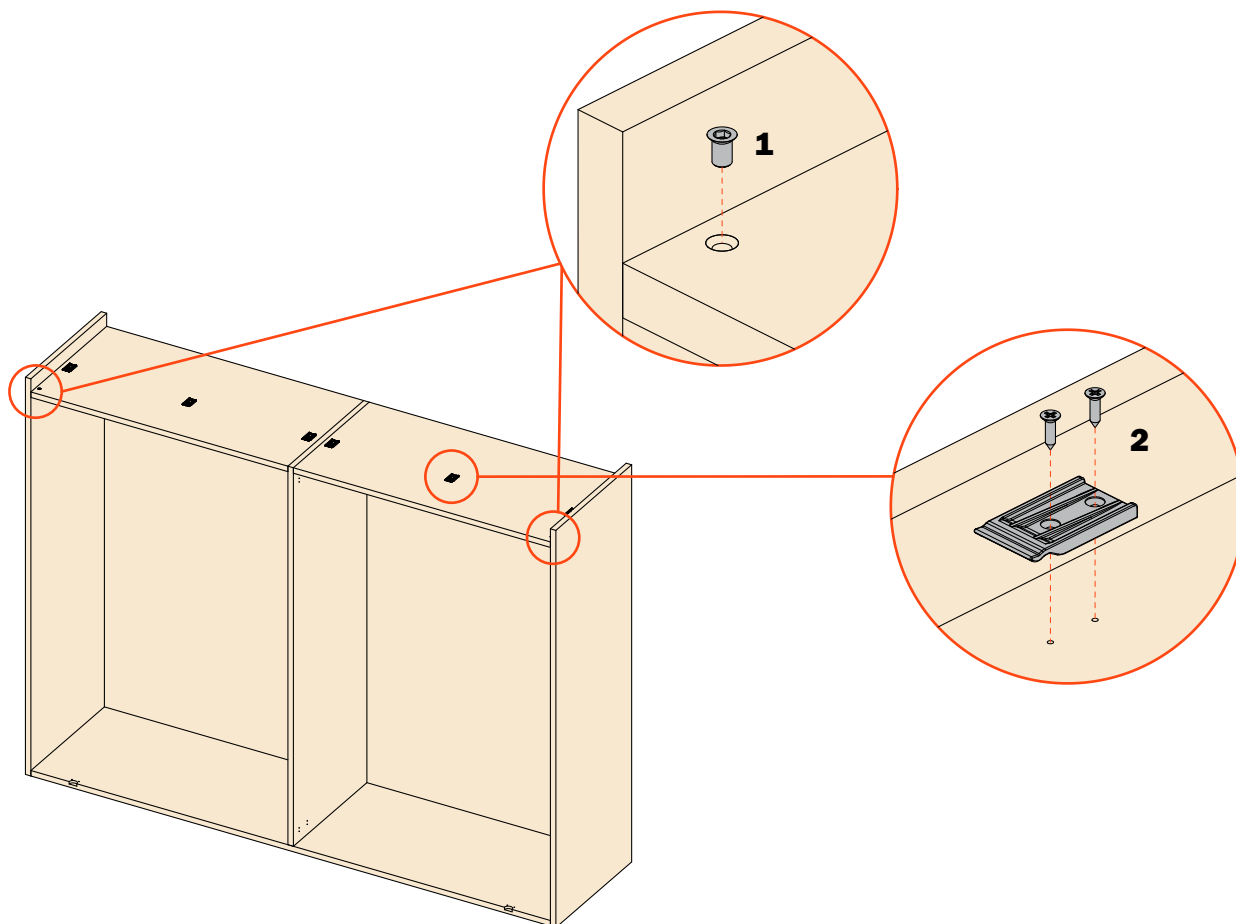

Check that the cabinet is level, plumb and free from distortion.

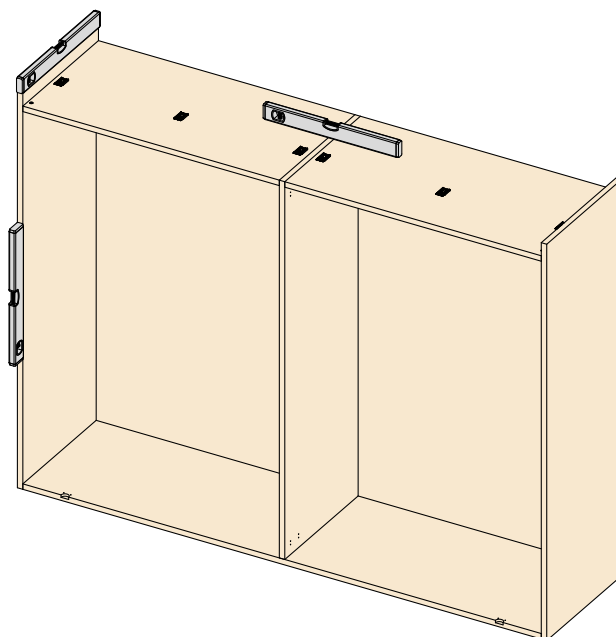

Place the mechanism to the top of the cabinet, making sure that the clips are securely engaged.

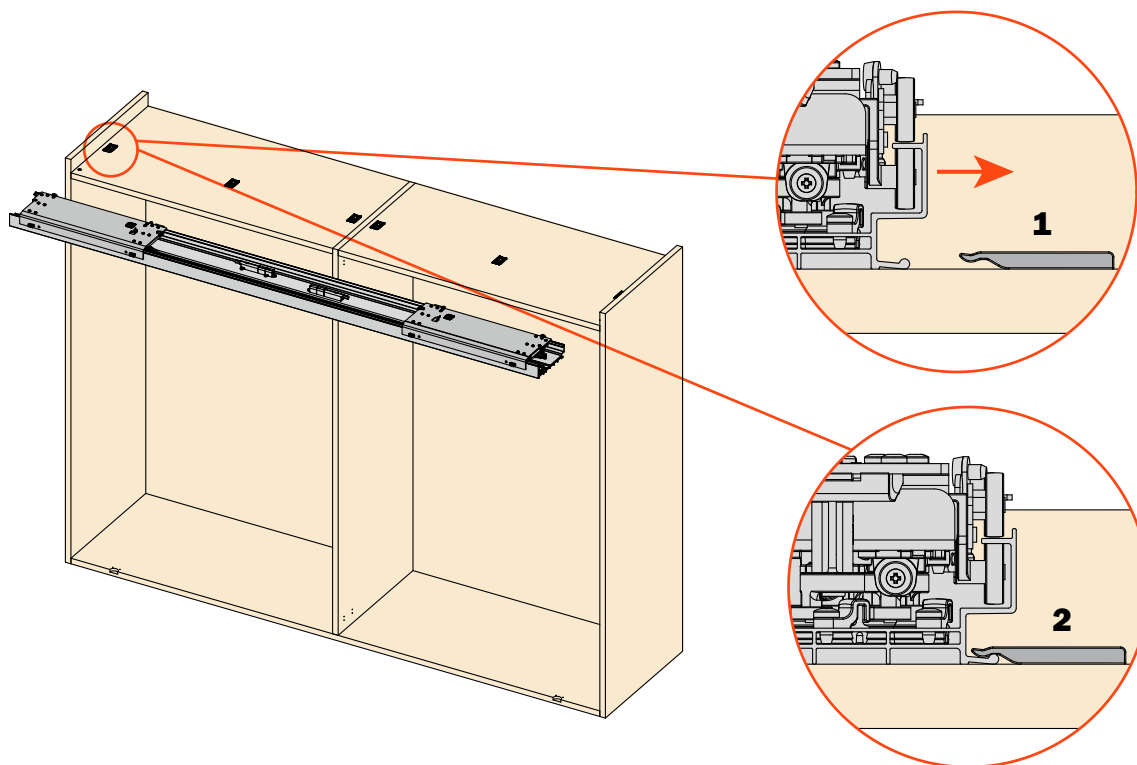

Fix the mechanism with the safety screws, pre-installed in the previously fixed dowels.

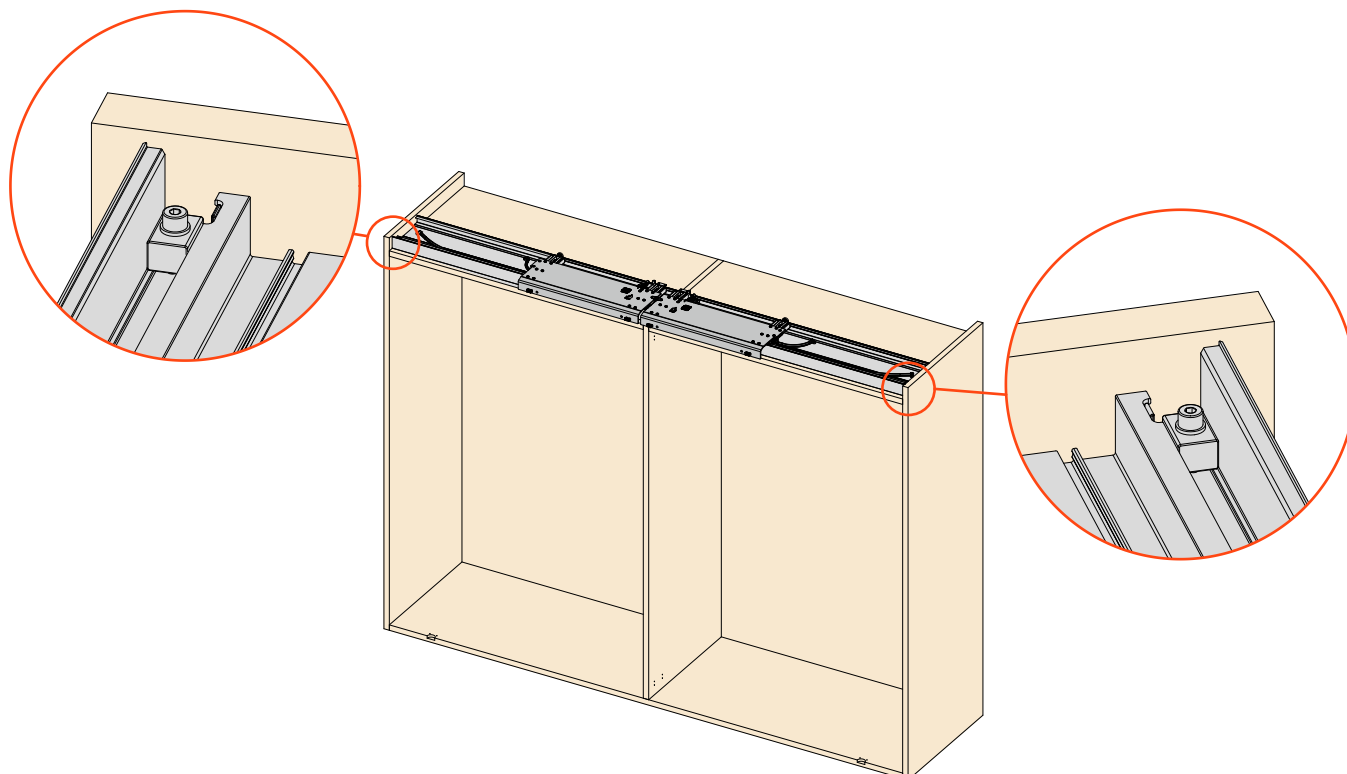

Insert the plates for the transmission rotation (1) in the pins installed at the ends of the transmission brackets.
Fix to the cabinet (2) with the screws provided.

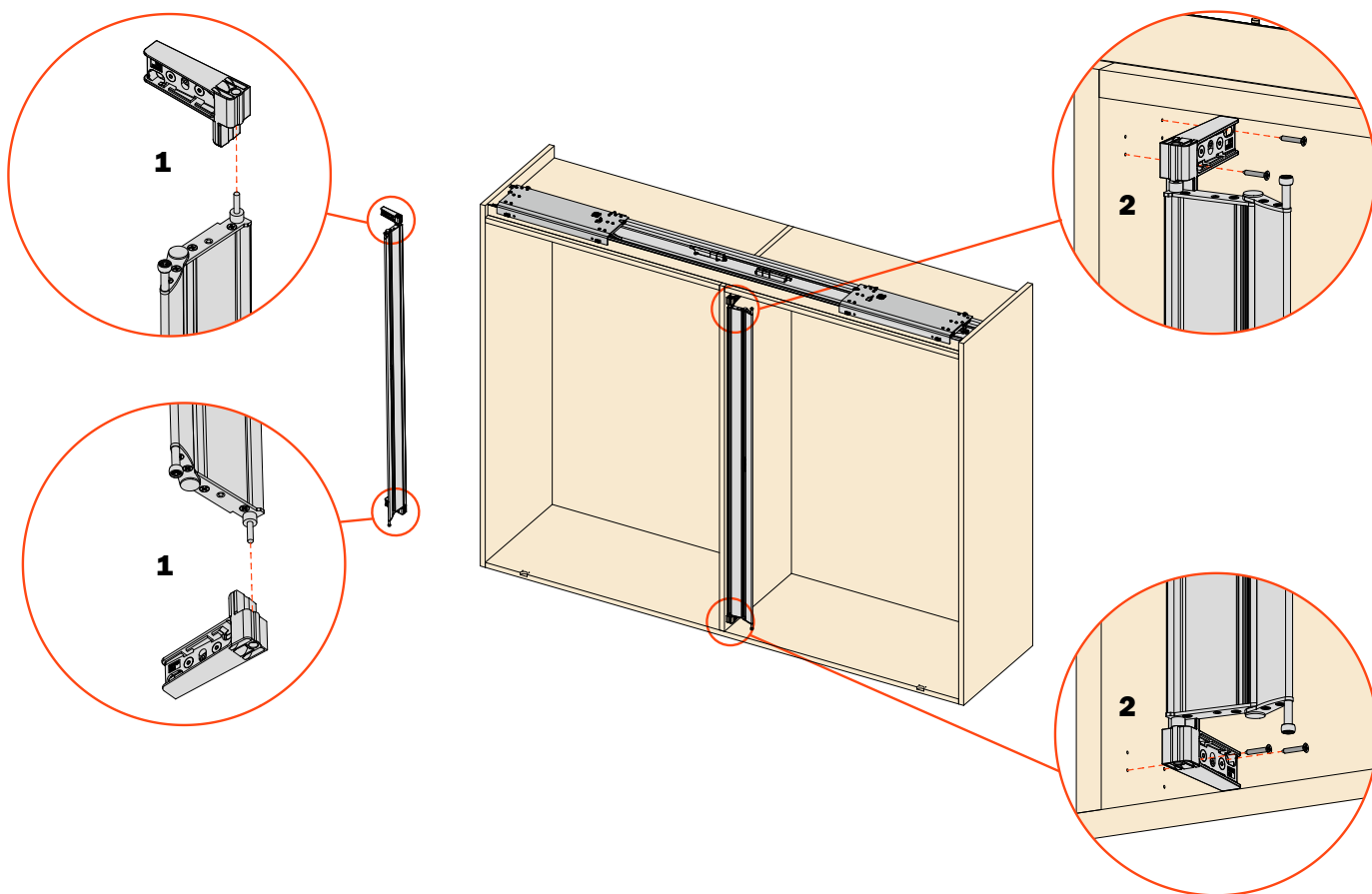

Repeat the operation on the other side of the central panel.

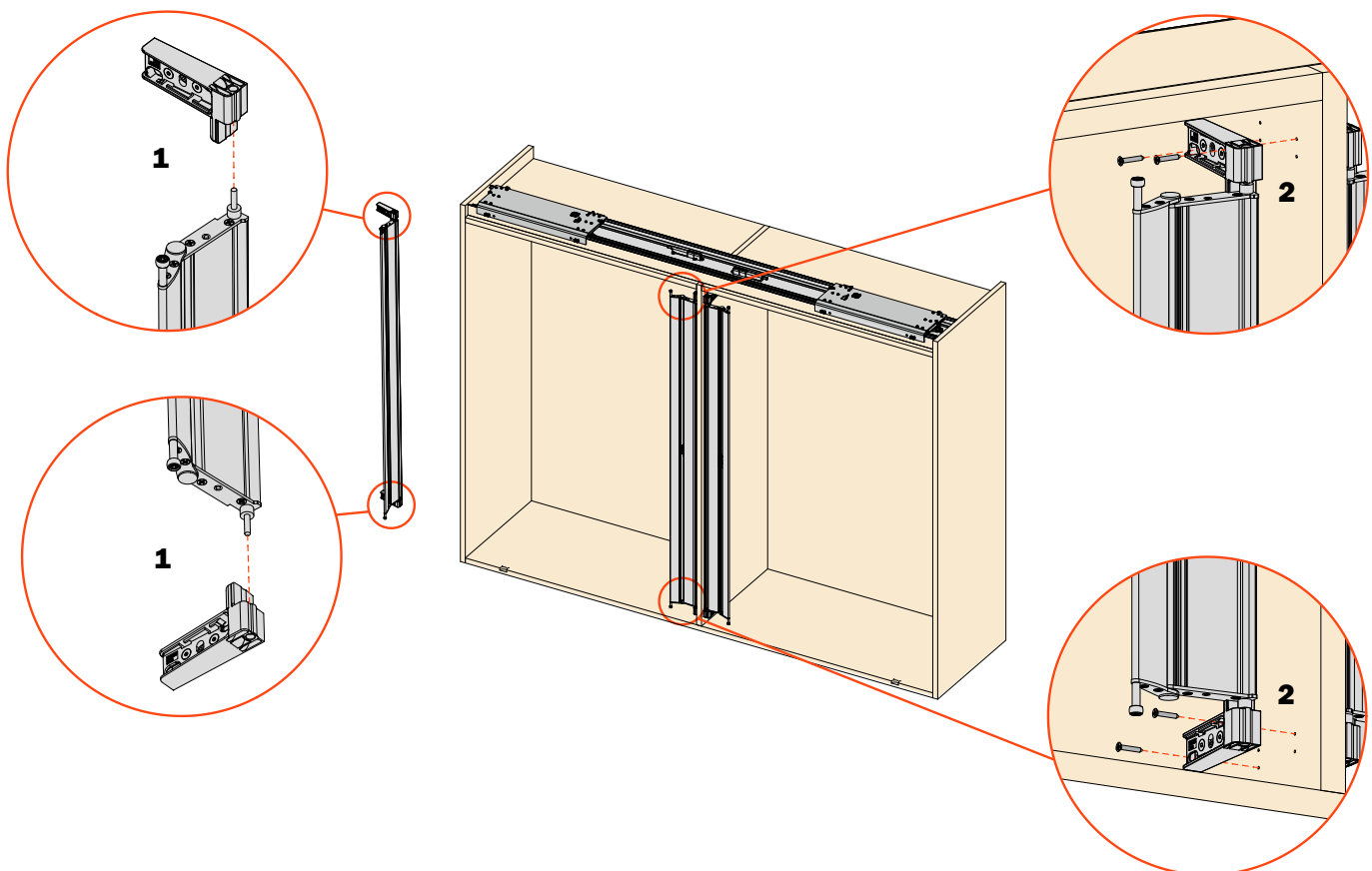

External adjusters

Fix the adjusters with the appropriate plastic supports, locating the one with the double adjustment to the inside of the door (1). Place the upper and the lower sliding profile with the slots towards the center of the door. Fix the runner stop from the inside of the door (2).

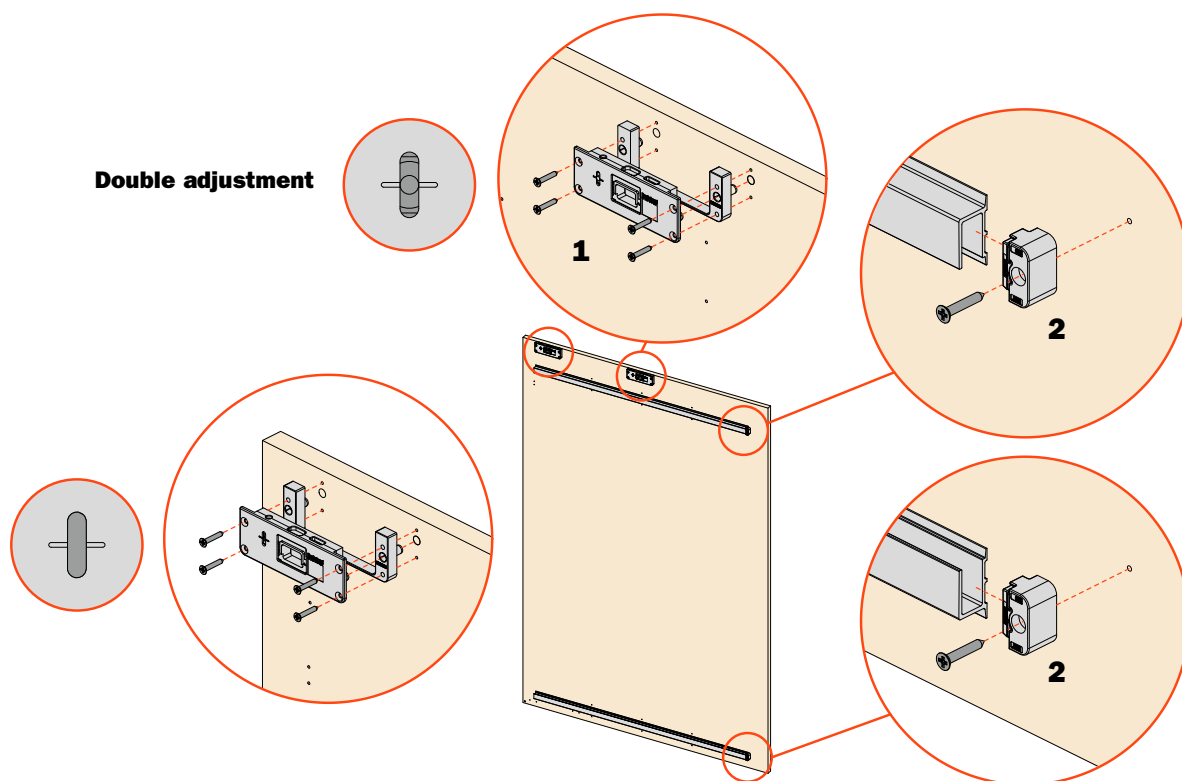

Recessed adjusters

Fix the adjusters using the previously made slots, locating the one with the double adjustment to the inside of the door (1). Place the upper and the lower sliding profile with the slots towards the center of the door. Fix the runner stop from the inside of the door (2).

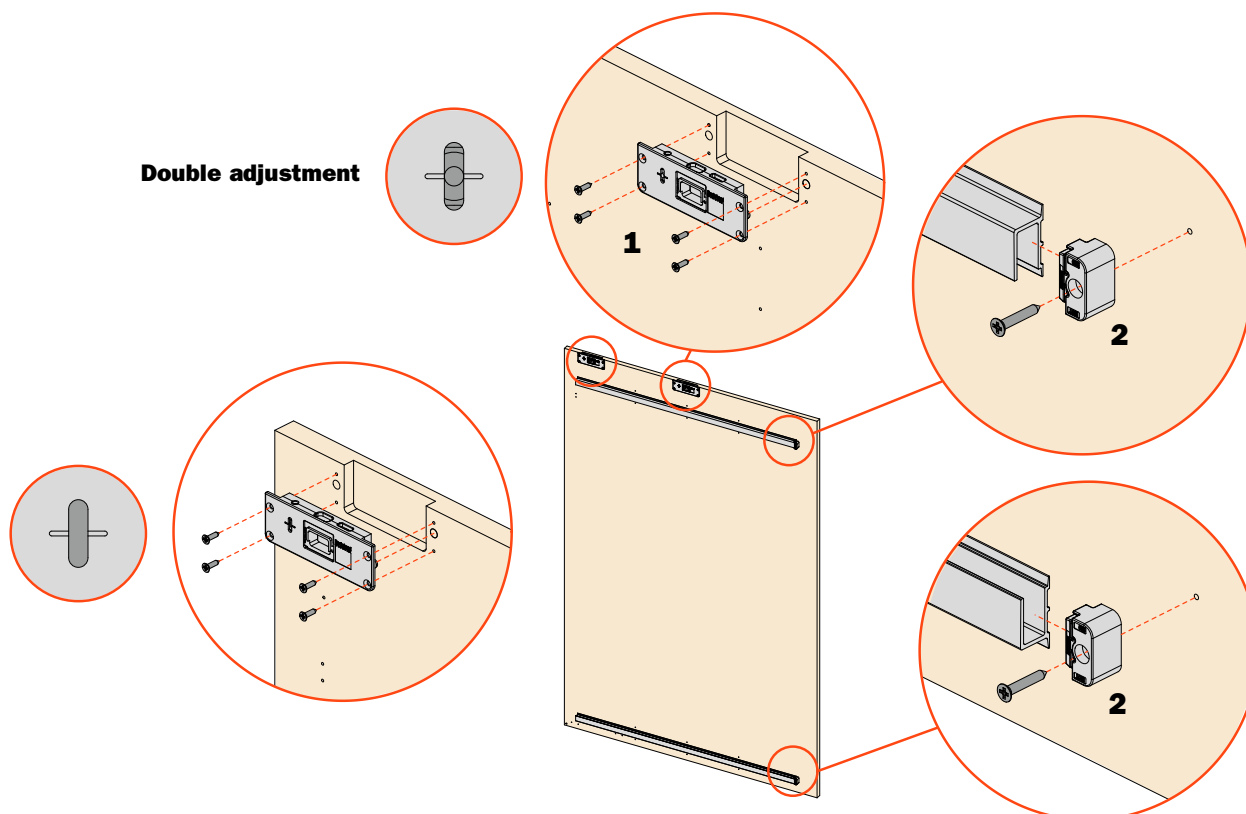

Fix the clips of the upper and lower sliding profile (1).
Fix the activator for the transmission bracket. (2).
Operations for both doors.

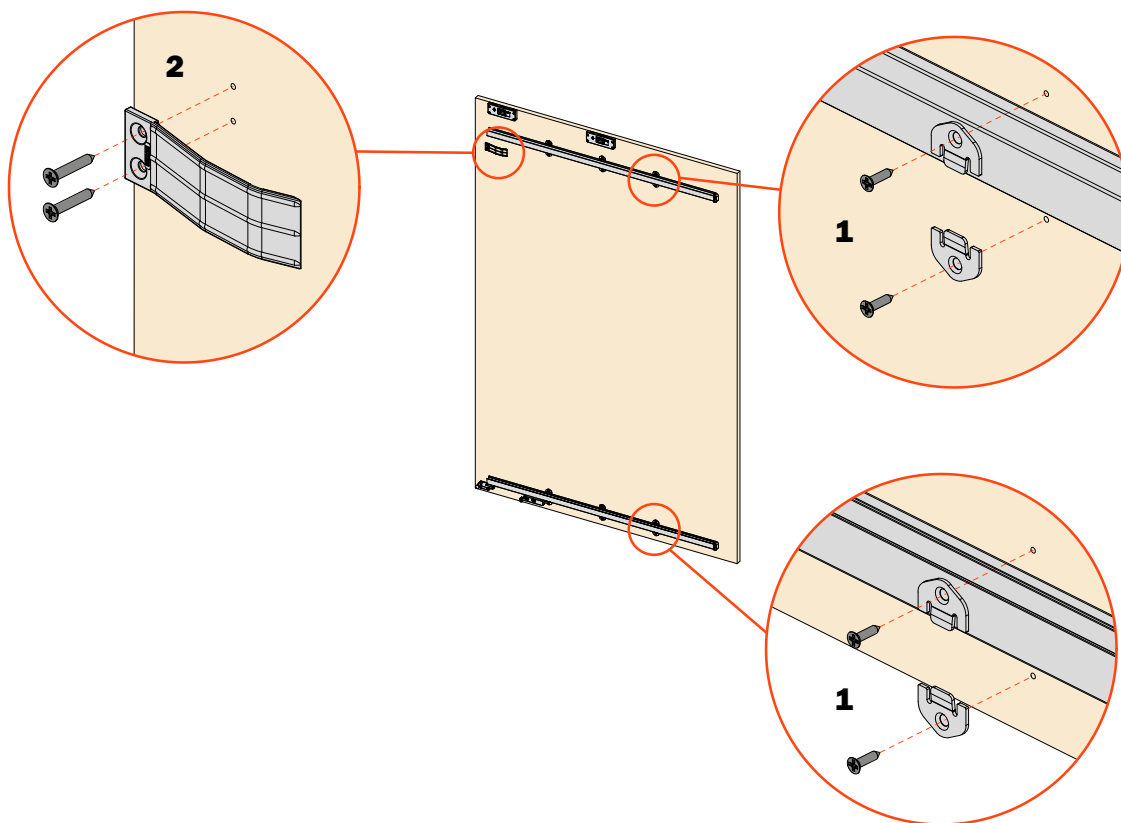

Fix the stabiliser of the door (1).
Fix the damper of the door (2).
Place the buffers (3).
Operations for both doors.

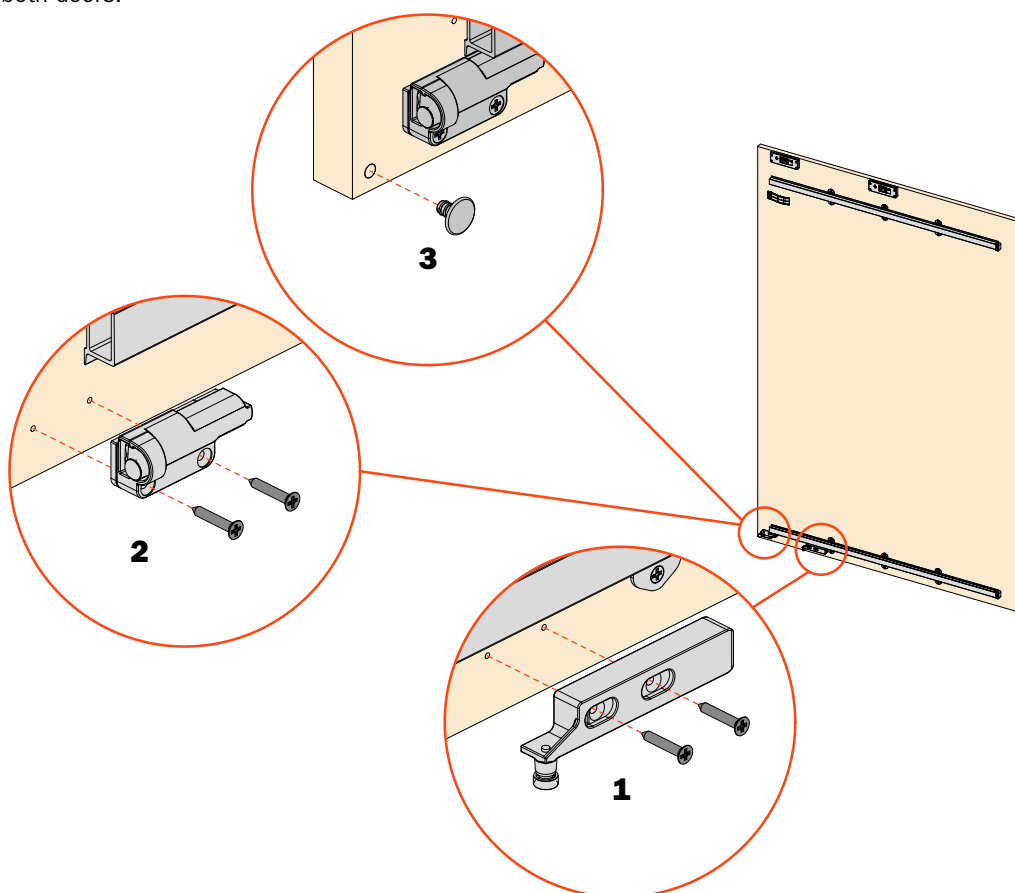

Fix the doors to the mechanism (1) with the screws provided (2).
This operation must be carried out with the doors in the open position.

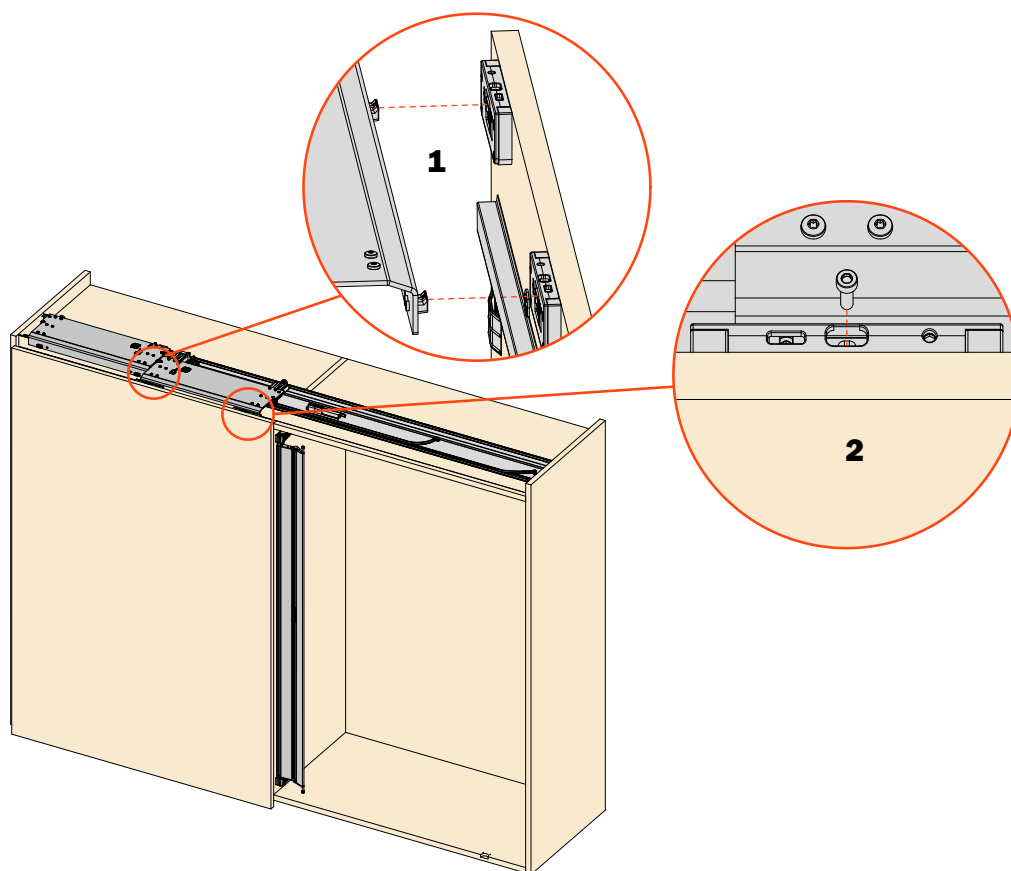

Fully open each door and insert the wheels of the transmission brackets into the profile slots (1).

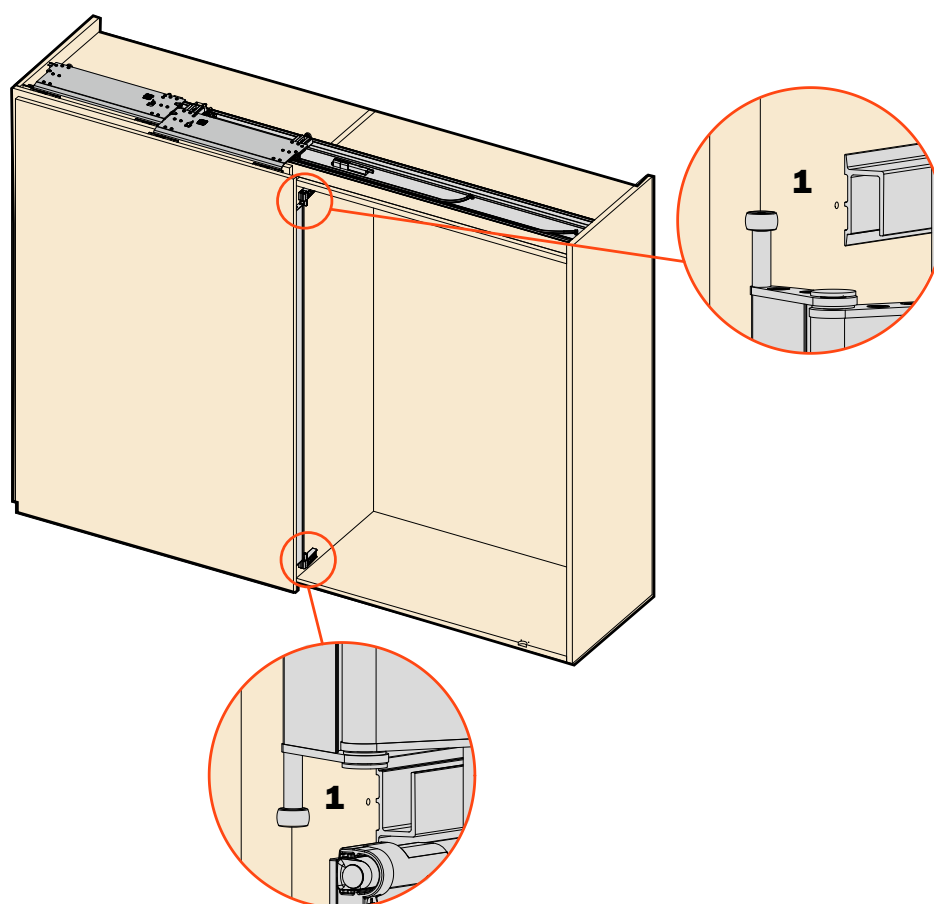

Fix on both doors the runner stop for doors (1).
Fix with the screws provided (2).

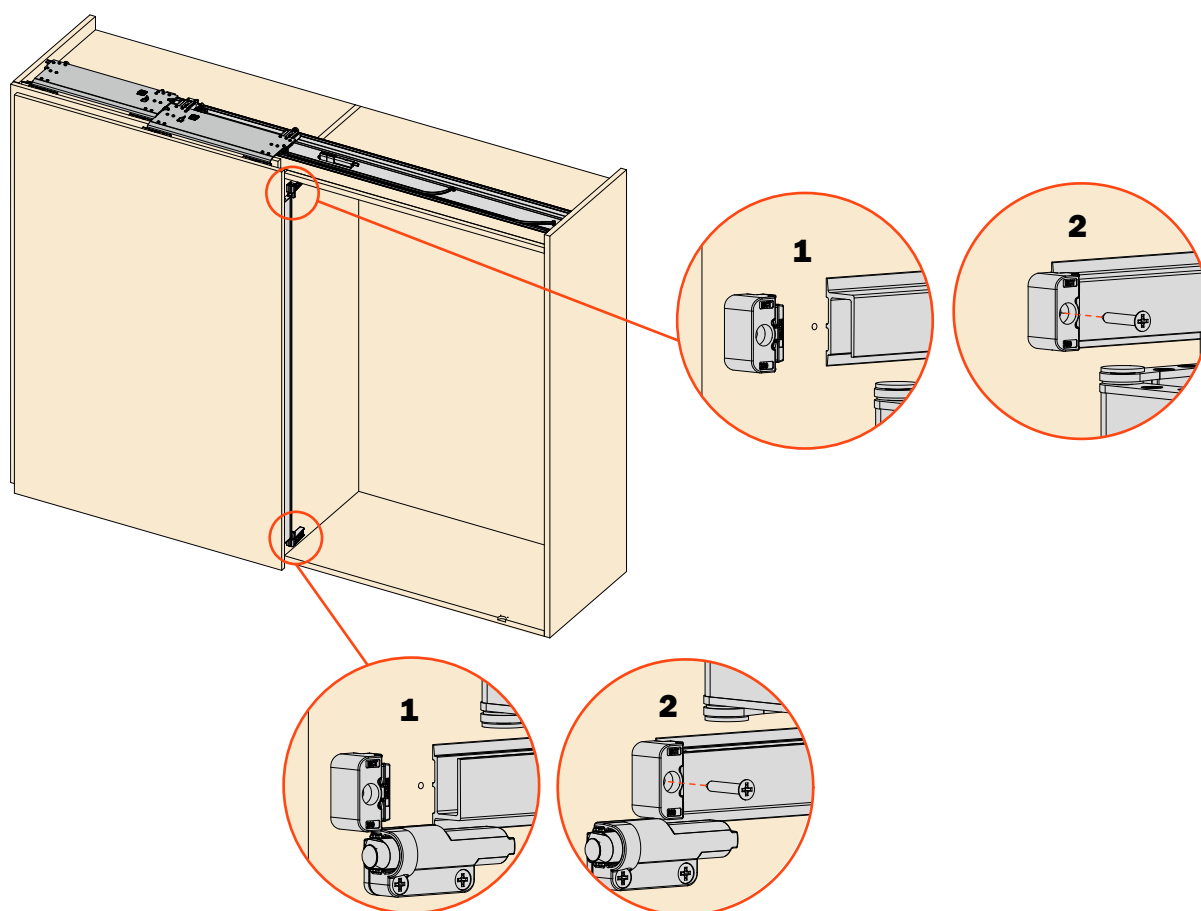

Open the doors and proceed with the sideways tilt adjustment.

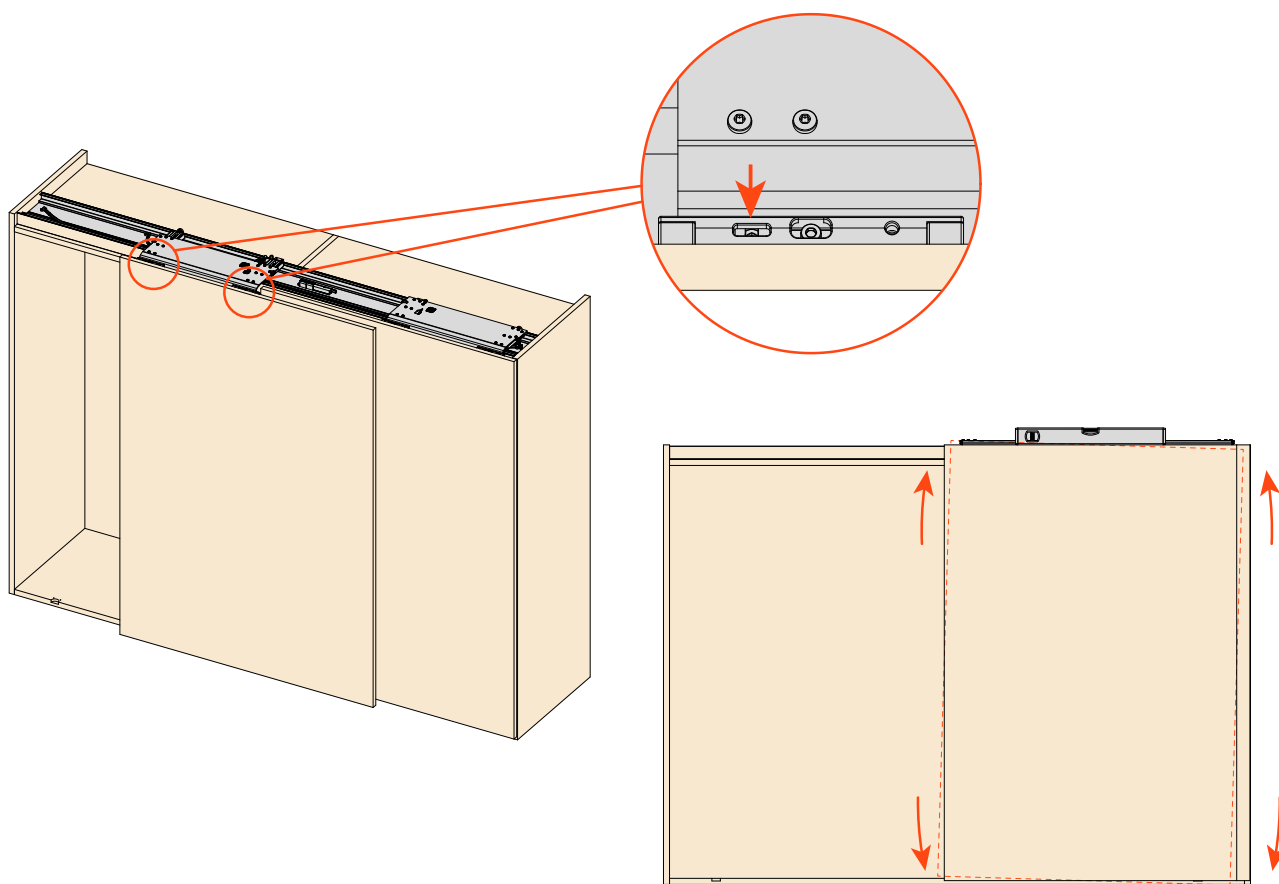

Open the doors and proceed with the vertical adjustment using the adjusters.

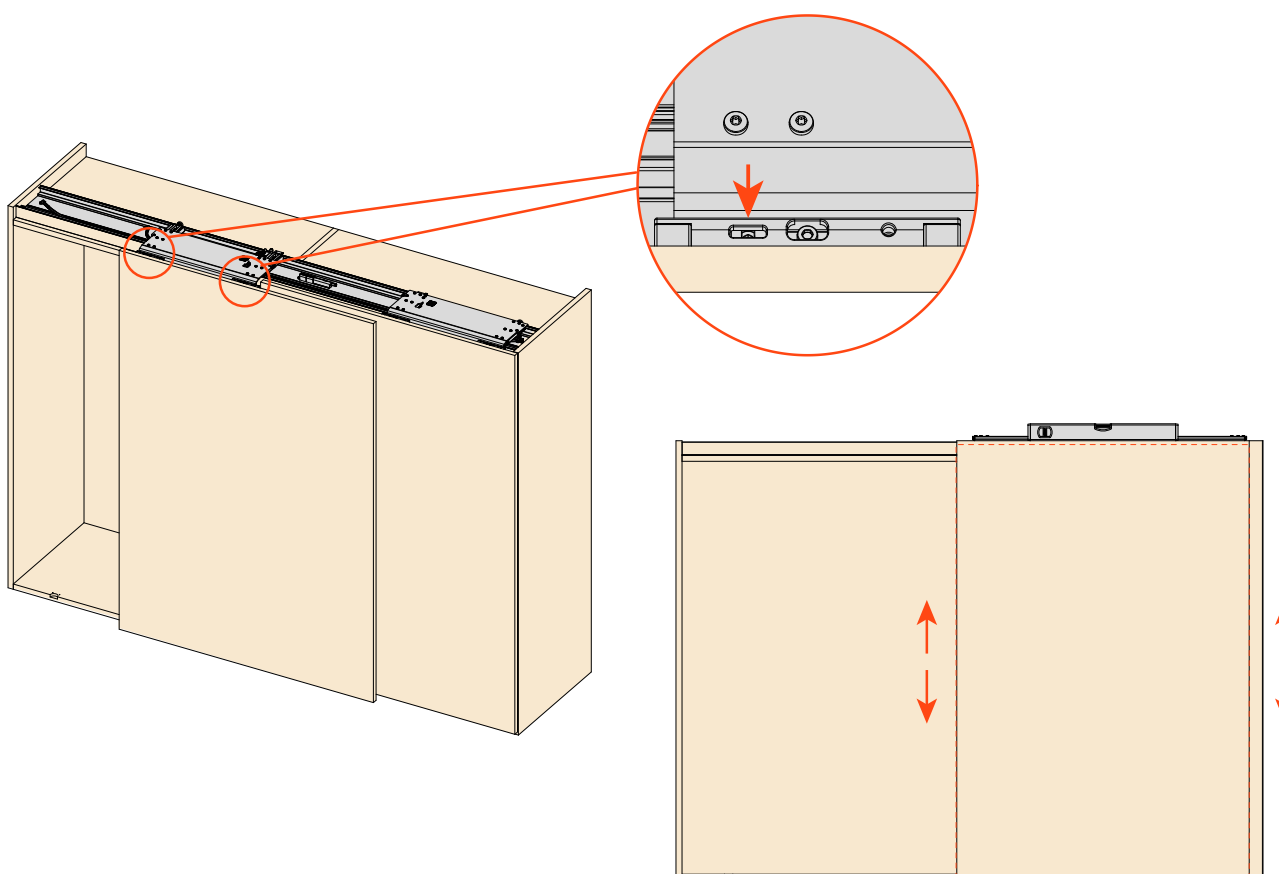

Adjust the dimension and the uniformity of the central reveal (4 mm) using the adjusters located towards the center of the cabinet.

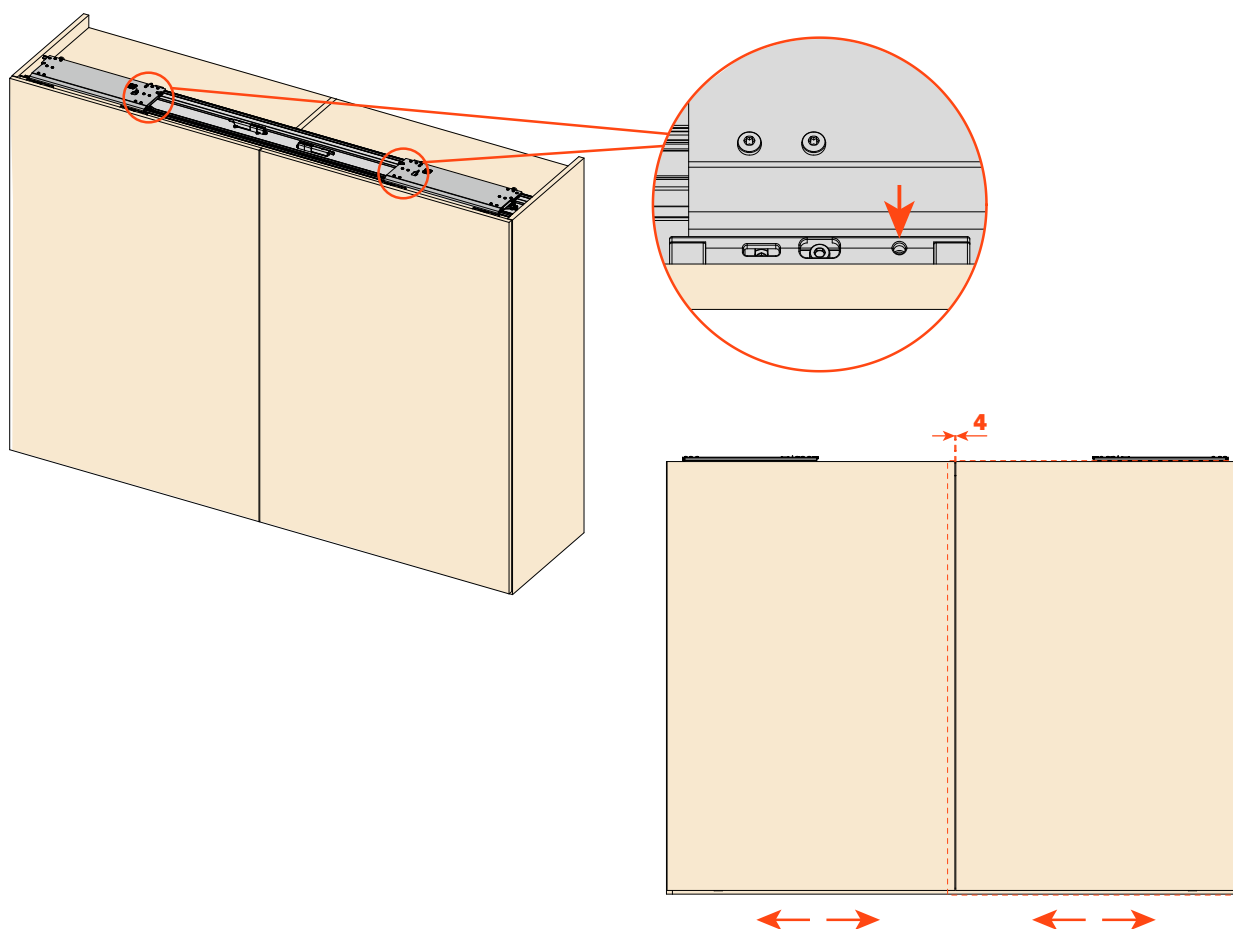

Adjust the depth of the upper part of the door (3 mm) using the screws located at the end of the carriages.

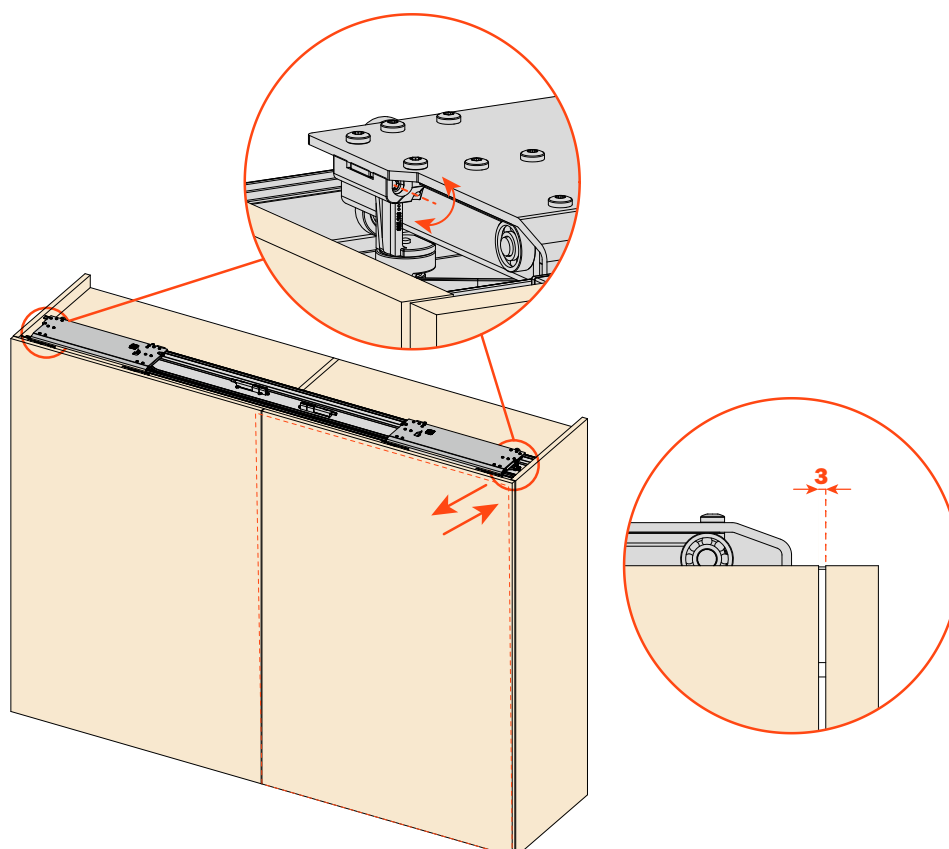

Adjust the depth of the lower part of the door (3 mm) loosening the fixing screws (1) and using the cam adjuster located on the plates for the rotation of the transmission brackets (2). Finally the fixing screws must be retightened.

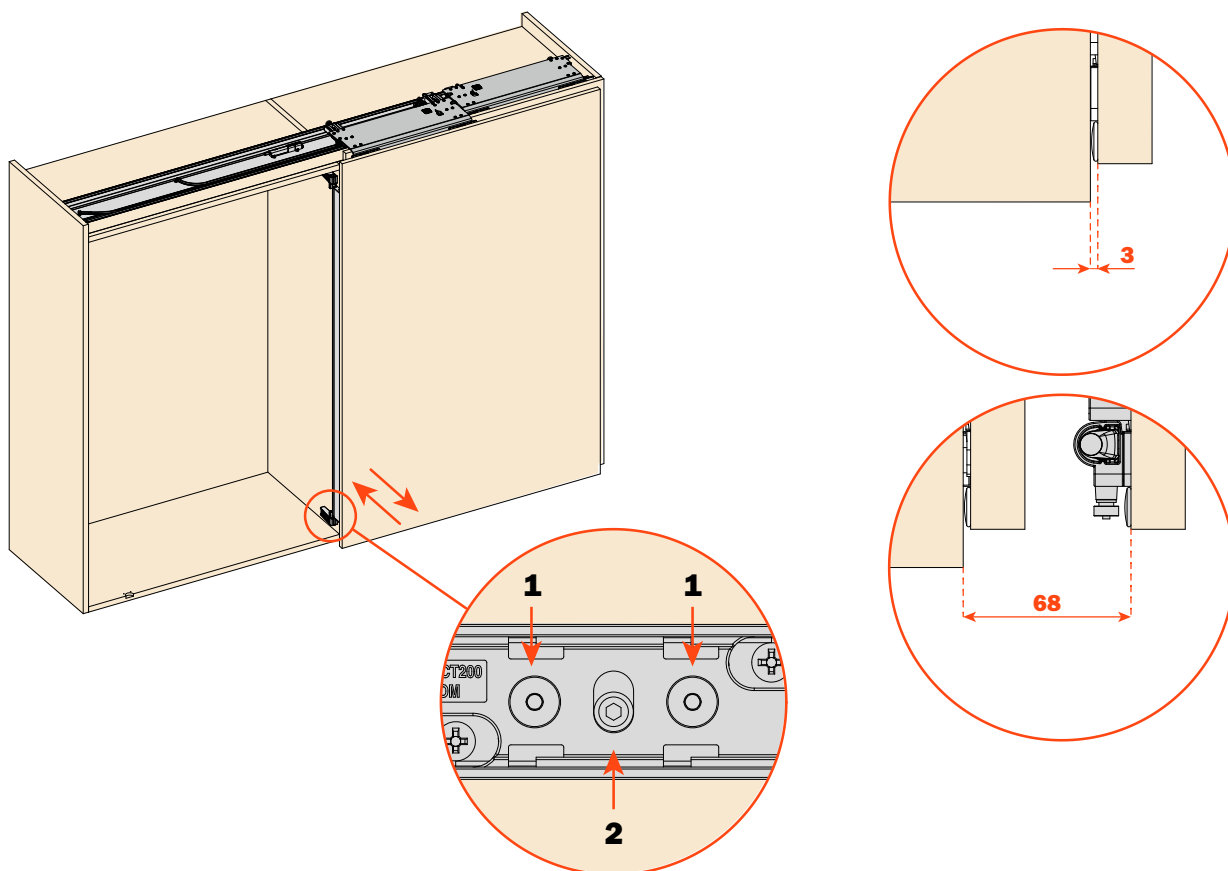

Fix the support for the stabiliser of the door on the base panel of the cabinet using the previously made slot.

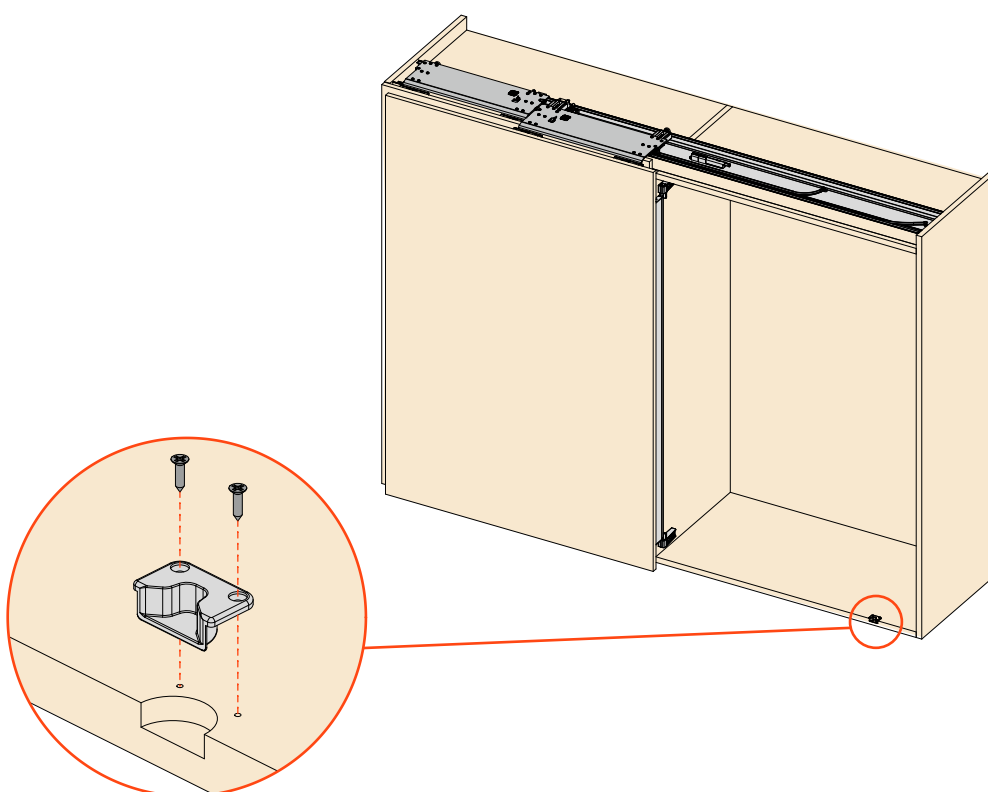

Loose the fixing screws on the stabiliser (1).
Close the doors and check if the position of the stabiliser is correct.
Finally the fixing screws must be retightened.

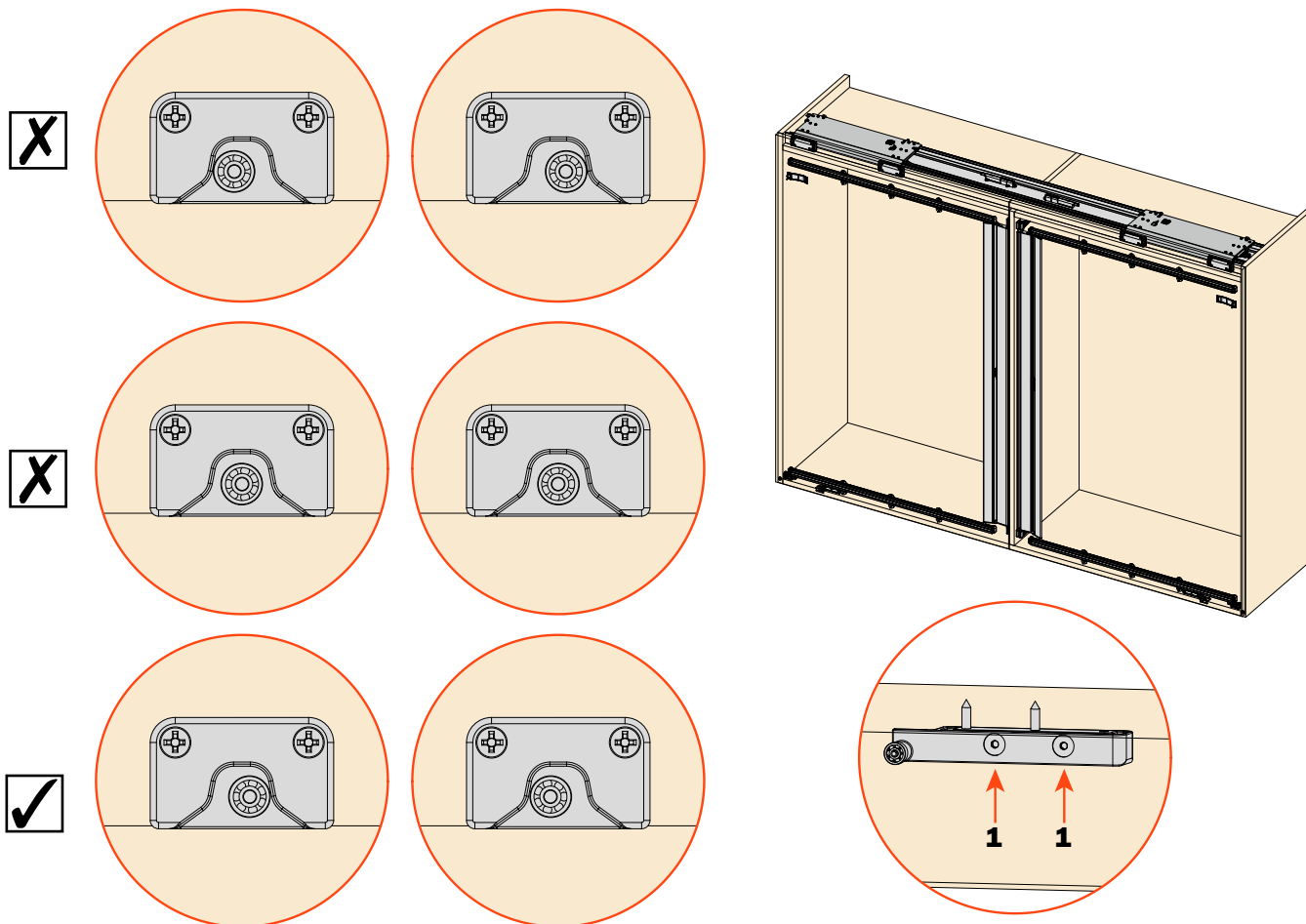

Fix the spacers as indicated.

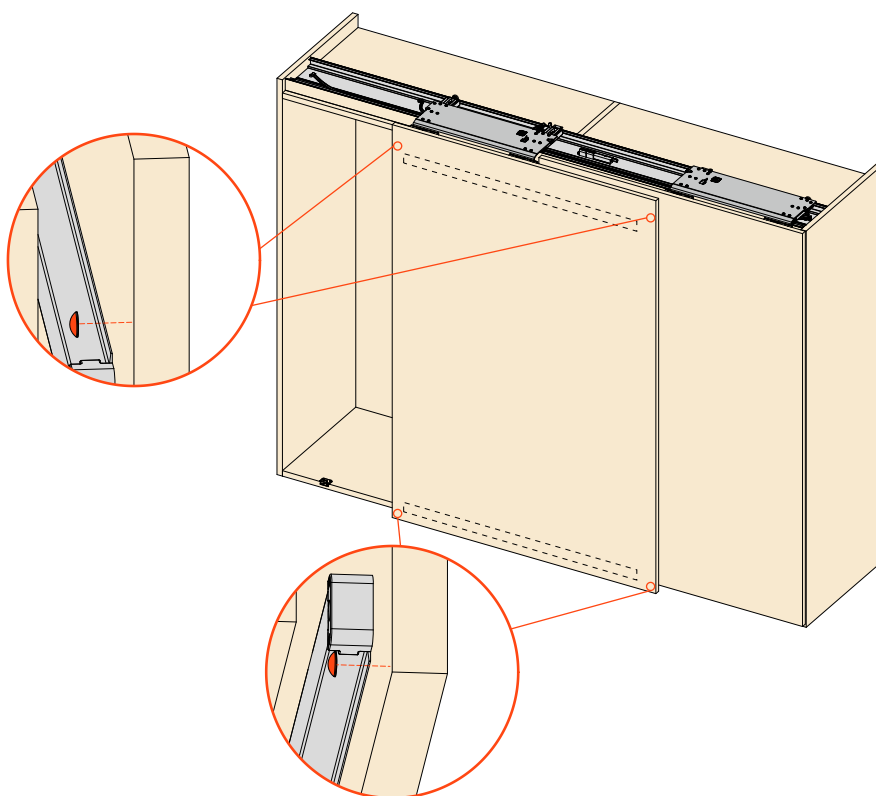

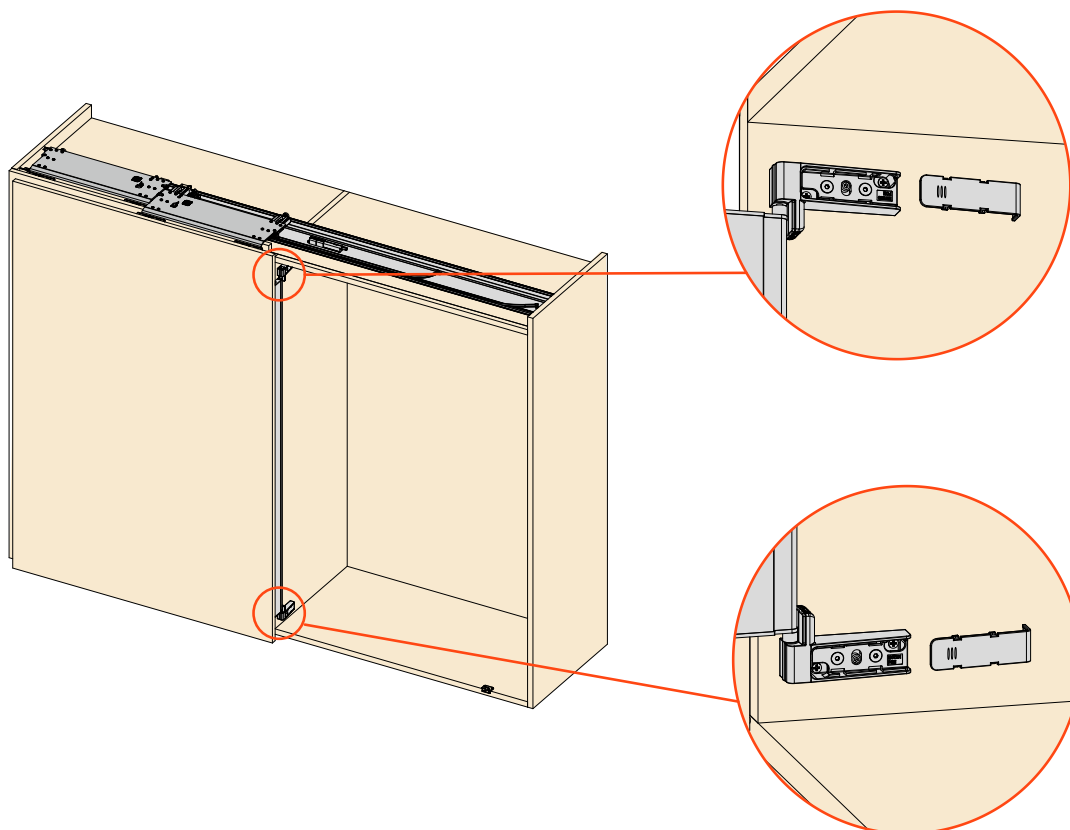

Fix the caps on the plates for the rotation.

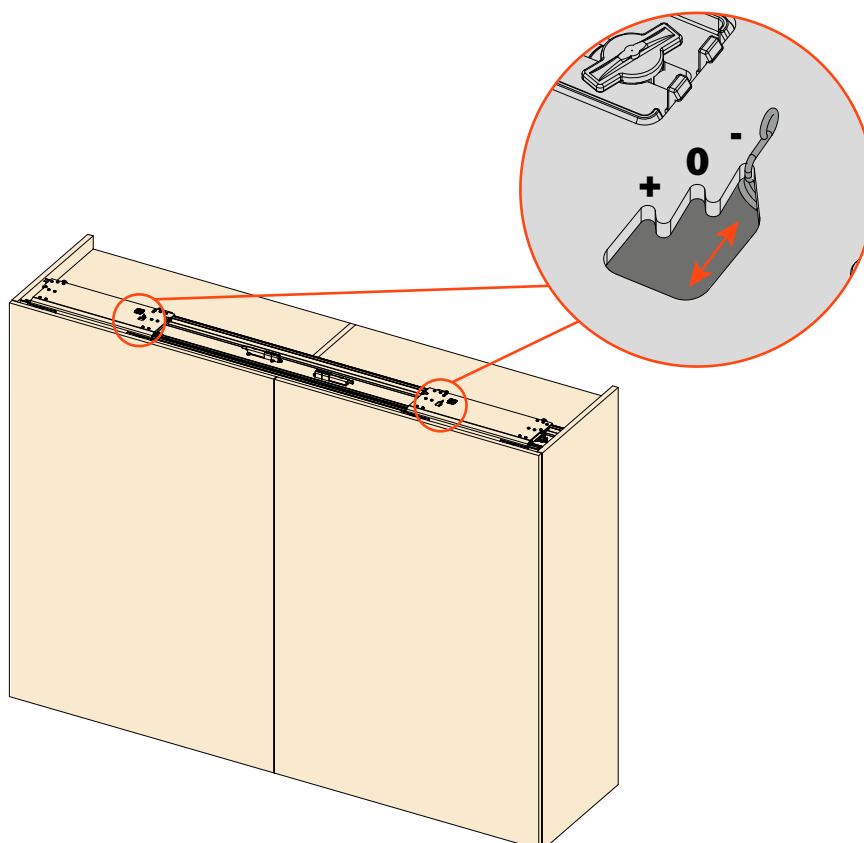

The closing speed of the doors can be adjusted changing the position of the springs located on the carriages.

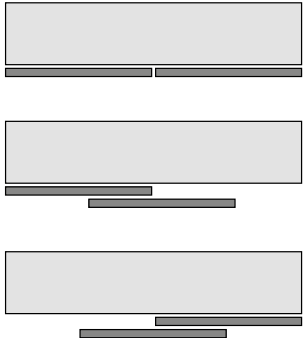
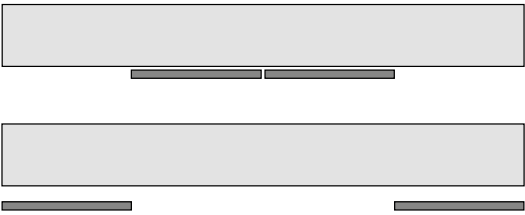
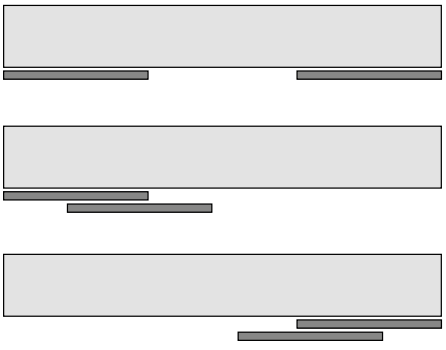

Slider M35	Description	Movement
Slider M35	Coplanar sliding system for the opening of two doors	
Slider M35 Top Reverso	Sliding system for the opening of two doors in the opposite direction	
Slider M35 Top Step	Sliding system for the opening of the doors separated by a central compartment	
Slider M35 Top One	Sliding system for the opening of a single door	
Slider M35 Top Power	Motorised sliding system for the opening of the doors	

ARTURO SALICE S.p.A.

VIA PROVINCIALE NOVEDRATESE, 10
22060 NOVEDRATE (COMO) ITALIA
TEL. 031 790424
FAX 031 791508
info.salice@salice.com
www.salice.com

DEUTSCHE SALICE GMBH

RUDOLF DIESEL STR. 10
POSTFACH 1154
74382 NECKARWESTHEIM
TEL. 07133 9807-0
FAX. 07133 9807-16
info.salice@deutschesalice.de
www.deutschesalice.de

DEUTSCHE SALICE GMBH

VERKAUFSBÜRO NORD
RINGSTRASSE 36/A30 CENTER
32584 LÖHNE
TEL. 05731 15608-0
FAX. 05731 15608-10
vknord@deutschesalice.de
www.deutschesalice.de

SALICE FRANCE S.A.R.L.

ROUTE DE GOA ZAC LES 3 MOULINS
06600 ANTIBES
TEL. 0493 330069
FAX. 0493 330141
info.salice@salicefrance.com
www.salicefrance.com

SALICE ESPAÑA, S.L.U.

CALLE COPÉRNICO, 11
POLÍGONO INDUSTRIAL
COLL DE LA MANYA
08403 GRANOLLERS (BARCELONA)
TEL. 938 46 88 61
FAX 938 49 11 97
info.salice@saliceespana.es
www.saliceespana.es

SALICE UK LTD.

KINGFISHER WAY
HUNCHINGBROOKE BUSINESS PARK
HUNTINGDON CAMBS PE 29 6FN
TEL. 01480 413831
FAX. 01480 451489
info.salice@saliceuk.co.uk
www.saliceuk.co.uk

SALICE AMERICA INC.

2123 CROWN CENTRE DRIVE
CHARLOTTE NC. 28227
TEL. 704 8417810
FAX. 704 8417808
info.salice@saliceamerica.com
www.saliceamerica.com

SALICE CANADA INC.

3500 RIDGEWAY DRIVE,
UNIT#1
MISSISSAUGA, ONTARIO, L5L 0B4
TEL. 905 8208787
FAX. 905 8207226
info.salice@salicecanada.com
www.salicecanada.com

SALICE CHINA (SHANGHAI) CO. LTD.

1st FLOOR, B1 BLDG 928 MINGZHU ROAD
XUJING, QINGPU DISTRICT
SHANGHAI 201702 - CHINA
Tel. 021 3988 9880
Fax 021 3988 9882
info.salice@salicechina.com
www.salicechina.com



Digital contents:

- **Technical pamphlet in Pdf format**

We reserve the right to change technical specifications without notice.

DOCASS009ENG
Ed. 03 - 05/2019

