

ZARGEN

DRAWER SYSTEM



THE 2 MINUTE DRAWER

From residential and office furniture to commercial and institutional settings, the versatile and reliable ZARGEN System delivers the superior performance one expects from a premium slide. Offering five side heights and flexible railing systems, the Zargen drawer provides endless possibilities for a well organized storage system. Made in the USA, the Zargen System offers side and height adjustments so you get perfect alignment every time.

Product: Single Wall Steel Drawer System

Mounting: Side

Material: Steel with Corrosion Resistant Finish

Hole Pattern: 32mm

Type: Steel Drawer System

Travel: Partial Extension

Length: 270mm (10 5/8"), 350mm (13 3/4"),
400mm (15 3/4"), 440mm (17 3/8"),
470mm (18 1/2"), 510mm (20 1/16"),
550mm (21 5/8")

Clearance: 15.5mm (5/8") on Each Side

Height(s): 43mm (1 11/16"), 85mm (3 3/8"), 117mm
(4 5/8"), 149mm (5 7/8"), 213mm (8 3/8")

Action: Roller Glide

Slide Configuration: Handed

Finish: White Epoxy Steel

Packaging: All Sizes 10 Sets per Corrugated Carton
Bulk Packaging Available

RAPID ASSEMBLY WITH ZRAM



ZARGEN
2 MINUTE
DRAWER SLIDE



ZARGEN
FULL CATALOG

Made in the USA, the ZARGEN metal drawer system has provided cabinet makers the quality and functionality expected of Grass hardware along with the flexibility to design your own drawer space.



The versatile metal drawer system offers deep drawers, standard drawers, pencil drawers, and roll out trays. Zargen offers endless possibilities for the end user.

- Integrated drawer slide and drawer side
- White epoxy finish
- Load capacity: 100 lb dynamic, 100 lb static
- Installation width 15.5mm (5/8")
- Available in five drawer heights, 43mm (1 11/16"), 85mm (3 3/8"), 117mm (4 5/8"), 149mm (5 7/8"), 213mm (8 3/8")

ZARGEN meets and exceeds ANSI/BHMA A156.9 Grade 1 testing requirements.

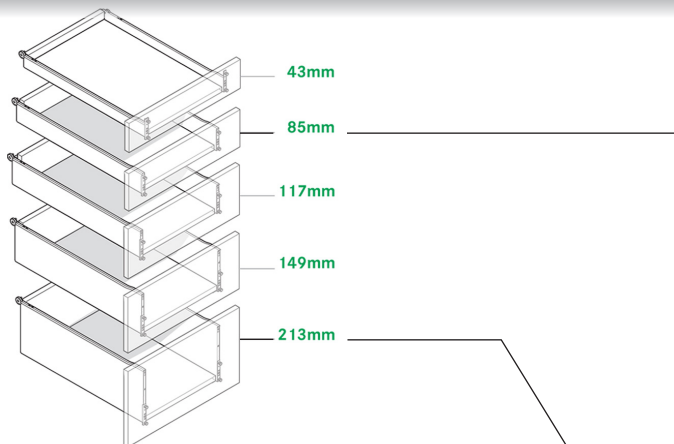

Cabinet Member

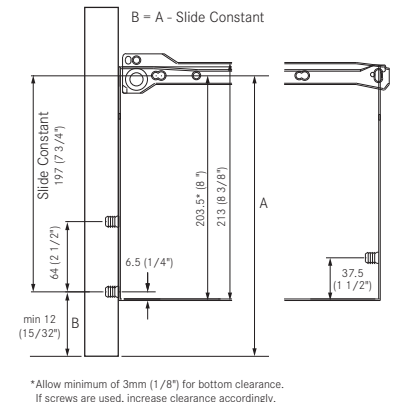
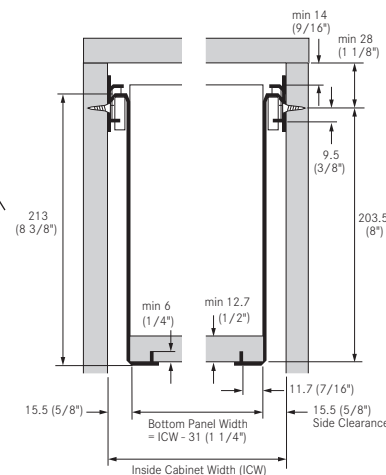
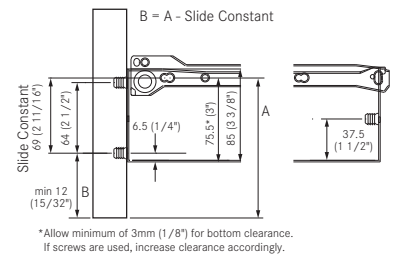
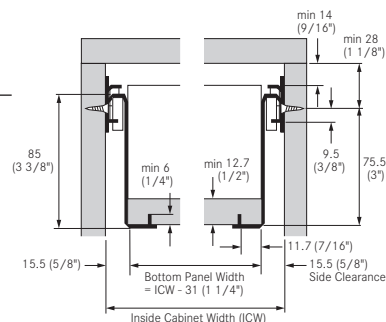
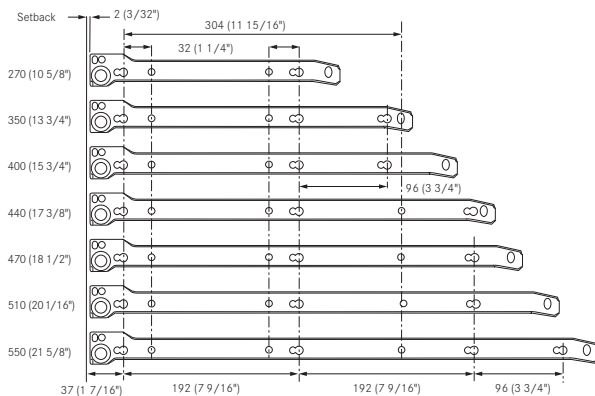

Quick assembly
with integrated front fixing brackets

Built in drawer front bumpers
protect the drawer front during closing

Parallel closing action keeps
the drawer front properly aligned

