



KNAPE & VOGT

STANDARDS & BRACKETS**KV 80 SLOTTED STANDARD**

Steel

1" Adjustment,
Width: 5/8", Height: 13/32"
All sizes 10/box.



Use with the KV 180 Brackets shown in the
next column. Pack: 10 each/box.

Anochrome

<u>Code</u>	<u>Size</u>	<u>List/ea</u>
80A-24	24"	\$ 4.86
80A-36	36"	8.96
80A-48	48"	10.47
80A-60	60"	12.71
80A-72	72"	21.05
80A-84	84"	20.79
80A-96	96"	19.72

White

<u>Code</u>	<u>Size</u>	<u>List/ea</u>
80WH-48	48"	\$ 12.08
80WH-60	60"	13.06
80WH-72	72"	19.02

KV 180 BRACKETS

Steel



1" Adjustment
Use with KV 80 standards

Pack: 10 each/box.

Anochrome

<u>Code</u>	<u>Size</u>	<u>List/ea</u>
180A-6	6"	\$ 4.03
180A-8	8"	4.13
180A-10	10"	4.51
180A-12	12"	7.45
180A-14	14"	8.88
180A-16	16"	8.04
180A-18	18"	10.21
180A-20	20"	11.96

White

180WH-6	6"	\$ 5.03
180WH-10	10"	4.78
180WH-12	12"	5.10
180WH-14	14"	7.20
180WH-16	16"	6.97
180WH-18	18"	10.00



KV BRACKETS

KV 183 HEAVY DUTY FLANGED BRACKET

Steel, Anochrome finish



Right, Left, Center
Heavy Duty
#183 angle Slot bracket
(1" increments)

Rights/Lefts priced the same. Pack: 10 each.

Left	Right	List	Center	List
183A-L-8	183A-R-8	\$ 9.74	183A-C-8	\$ 15.22
183A-L-10	183A-R-10	10.70	183A-C-10	15.96
183A-L-12	183A-R-12	11.84	183A-C-12	17.23
183A-L-14	183A-R-14	13.52	183A-C-14	18.93
183A-L-16	183A-R-16	15.36	183A-C-16	20.92
183A-L-18	183A-R-18	17.09	183A-C-18	23.22
183A-L-20	183A-R-20	18.81	183A-C-20	25.24

KV 185 HEAVY DUTY DOUBLE BRACKET

Steel, Anochrome finish



Heavy Duty #185
Double Slot bracket
(1" increments)

Pack: 10 each

Code	List/ea	Code	List/ea
185A-12	\$ 14.51	185A-20	\$ 23.02
185A-14	16.11	185A-22	29.19
185A-16	17.35	185A-24	30.29
185A-18	18.02		

KV 160 LOCK LEVER BRACKETS

Steel, Anochrome finish, 1" Increments



#160 Lock Lever bracket

Features stabilizing lock-lever. Ideal for high traffic displays. Other sizes available Special Order.

Code	Size	Ctn	List/ea
160A-12	12"	10 ea.	\$ 7.77

KV 186 & KV 187 HEAVY DUTY BRACKETS

Steel, Anochrome finish, 2" Increments



#186 Slot bracket
Extra Heavy Duty



#187 Slot bracket
Extra Heavy Duty

Pack: 5 each

Code	List/ea	Code	List/ea
186A-8	\$ 11.90	187A-16	\$ 17.03
186A-10	12.54	187A-18	18.50
187A-12	15.03	187A-22	25.86
187A-14	15.11	187A-24	27.57

RESTS FOR #186/#187 BRACKETS Anochrome



Center
Rest
#211



Front
Rest
#212KV

Code	Description	Ctn	List/ea
211	Center Rest	100	\$ 1.62
212KV	Front Rest	100	1.66

RUBBER CUSHION

for #103, #104, #105, #210 & #211, #212 rests



#129
Cushion

Code	Description	Ctn	List/ea
129	Cushion	100	\$.47

KV 179 ADJUSTABLE SLANT BRACKETS

Steel, Anochrome finish, 1" Increments



#179 Adjustable bracket

Adjustable to 15°, 30°, 45° and 90°.

Code	Size	Ctn	List/ea
179A-12	12"	10	\$ 18.25
179A-14	14"	10	19.09

SHELF STANDARDS

KV 71 - NARROW STANDARD - Special Order

Steel, Anochrome finish, 1" Increments

<u>Code</u>	<u>Size</u>	<u>Ctn</u>	<u>List/ea</u>
71A-4*	48"	10 ea.	\$ 32.19
71A-5*	60"	10	39.08
71A-6*	72"	10	54.51
71A-8*	96	10	64.98

KV 83 - HEAVY DUTY OVERSIZED STANDARD

Steel, Anochrome finish, 1" Increments

<u>Code</u>	<u>Size</u>	<u>Ctn</u>	<u>List/ea</u>
83A-2	24"	10 ea.	\$ 8.54
83A-3	36"	10	11.18
83A-4	48"	10	14.92
83A-5	60"	10	18.70
83A-6	72"	10	22.24
83A-7	84"	10	26.16
83A-8	96"	10	28.11

KV 85 - DBL SLOTTED HEAVY DUTY STANDARD

Steel, Anochrome finish, 1" Increments

<u>Code</u>	<u>Size</u>	<u>Ctn</u>	<u>List/ea</u>
85A-3	36"	10 ea.	\$ 11.90
85A-4	48"	10	15.76
85A-5	60"	10	19.45
85A-6	72"	10	23.63
85A-7	84"	10	27.23
85A-8	96"	10	32.67

KV 87 - EXTRA HEAVY DUTY STANDARD

Steel, Anochrome finish, 2" Increments

Pack: 5 each.

<u>Code</u>	<u>Size</u>	<u>List/ea</u>	<u>Code</u>	<u>Size</u>	<u>List/ea</u>
87A-2	24"	\$ 15.93	87A-6	72"	\$ 43.80
87A-3	36"	22.31	87A-7	84"	58.78
87A-4	48"	31.80	87A-8	96"	56.96
87A-5	60"	36.46			



#71 Slotted Narrow

5/16" Width
13/32" Deep

#83 Slotted Heavy Duty Oversized

3/4" Width
1/2" Deep

#85 Double Slotted Heavy Duty

1-1/4" Width
1/2" Deep

#87 Slotted Extra Heavy Duty

7/8" Width
11/16" Deep

#71, 83, 85 are 1" increments, #87 are 2" increments

[illegible]

Standards & Bracket Selection Chart

This chart lists all of the many standards and brackets manufactured by Knappe & Vogt. It will enable you to determine which bracket to use with each standard.



SHELF STANDARDS

KV STANDARDS 233 Surface Mount

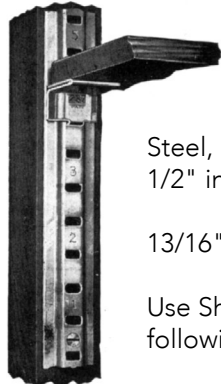

All Special Order

Steel, Surface Mounted,
1/2" increments.

13/16" Width x 3/16" Deep.

Use Shelf Supports on
following page.

Code	Description	Ctn	List/ea
233ZC-24*	Zinc (Steel), 24"	100	\$ 1.68
233ZC-36*	" " 36"	100	2.64
233ZC-48*	" " 48"	100	3.66
233ZC-60*	" " 60"	100	4.47
233ZC-72*	" " 72"	50	5.31
233ZC-96*	" " 96"	50	7.11

KV STANDARDS 255 Flush or Surface Mount

Flush or Surface Mounted,
1/2" increments.

5/8 Width x 3/16" Deep.

Use Shelf Supports on
following page.



Steel, Zinc Finish

Code	Description	Ctn	List/ea
255ZC-24	Zinc, 24"	100	\$ 2.14
255ZC-30	" 30"	100	2.58
255ZC-36	" 36"	100	3.30
255ZC-48	" 48"	100	4.18
255ZC-60	" 60"	100	4.82
255ZC-72	" 72"	50	5.84
255ZC-84	" 84"	50	7.51
255ZC-96	" 96"	50	8.24

(cont. next column)

KV STANDARDS 255 continued

Steel, Brass Finish



255BR-36	Brass, 36"	100	\$ 3.59
255BR-48	" 48"	100	5.46
255BR-72	" 72"	50	8.06
255BR-96	" 96"	50	10.09

Steel, White Finish



255WH-18	White, 18"	100	\$ 2.34
255WH-24	" 24"	100	2.49
255WH-36	" 36"	100	3.59
255WH-48	" 48"	100	4.90
255WH-60	" 60"	100	6.00
255WH-72	" 72"	50	7.24
255WH-84	" 84"	50	8.56
255WH-96	" 96"	50	9.73

Aluminum, Natural Aluminum Finish



255AL-24	Alum, 24"	100	\$ 2.78
255AL-30	" 30"	100	3.13
255AL-36	" 36"	100	3.43
255AL-48	" 48"	100	4.49
255AL-60	" 60"	100	6.03
255AL-72	" 72"	50	6.48
255AL-84	" 84"	50	8.15
255AL-96	" 96"	50	8.57

Aluminum, Walnut Finish**



255ALWAL-72	" 72"	50	\$ 8.27
255ALWAL-84	" 84"	50	11.27

**disc when out

**SHELF SUPPORTS****NAILS FOR KV 255 STANDARDS**

Pack: 650/bag. No broken bags.



<u>Code</u>	<u>Finish</u>	<u>Pack</u>	<u>List/bg</u>
255-81 BR	Brass	650/bg	\$ 12.04
255-81 WH	White	650	16.42
255-81 ZC	Zinc	650	15.12

KV 256 SHELF SUPPORTS

Use with KV 233 and 255 Standards

Pack: 100/Ctn.
Full Cartons Only.#256 Support
(1/2" increments)

<u>Code</u>	<u>Finish</u>	<u>Ctn</u>	<u>List/ea</u>
256ZC	Zinc (Steel)	100	\$.41
256BR	Brass (Steel)	100	.45
256WH	White (Steel)	100	.88
256ALM	Almond (Steel)	100	.71
256WAL	Walnut (Steel)	100	.48
256ALNAT	Natural Aluminum	100	.44

KV 256 BULK PACKPack: 1000/Ctn.
Full Cartons Only.

<u>Code</u>	<u>Finish</u>	<u>Ctn</u>	<u>List/ea</u>
256B-ZC	Zinc (Steel)	1000	\$.39

KV 256 IN POLYBAGS12 each per bag,
10 bags per box.

<u>Code</u>	<u>Finish</u>	<u>Ctn</u>	<u>List/bg</u>
256P-WH	White	10	\$ 11.41

KV 237 STEEL SHELF SUPPORTS

Use with KV 233 Standards

Zinc Finish.

#237 Support
(1/2" increments)

<u>Code</u>	<u>Ctn</u>	<u>List/ea</u>
237ZC	100	\$.68

KV 238 SHELF SUPPORTS w/ Locator Tab

Use with KV 233 Standards

Anochrome Finish.

#238 Support
(1/2" increments)

<u>Code</u>	<u>Ctn</u>	<u>List/ea</u>
238	100	\$.81

KV 239 STEEL SHELF SUPPORTS

Use with KV 233 and 255 Standards

Zinc Finish.

#239 Support
(1/2" increments)

<u>Code</u>	<u>Ctn</u>	<u>List/ea</u>
239ZC	100	\$.54

KV 243 SHELF SUPPORTS

Use with KV 233 and 255 Standards

Zinc Finish.
With 3" Cross Support#243 Support
(1/2" increments)

<u>Code</u>	<u>Ctn</u>	<u>List/ea</u>
243ZC	100	\$ 3.48



SHELF SUPPORTS

STEEL SHELF SUPPORTS

KV 345: 5mm Pin
 KV 346: 1/4" Pin
 KV 348: 5mm Pin (w/ vinyl cover)
 2607: 1/4" Pin
 2707: 5mm Pin



Code	Finish	Pin	Ctn	List
346NP	Anochrome	1/4"	100	\$.53 /ea
346BR	Brass	1/4"	100	.51
346WAL	Walnut	1/4"	100	.49
348ALM	Almond	5mm	100	.58
348BROWN	Brown	5mm	100	.58
2607BN	Nickel	1/4"	1000	\$ 25.48 /C
2607PB	Brass	1/4"	1000	21.96
2707BN	Nickel	5mm	1000	50.29
2707PB	Brass	5mm	1000	28.21
2707AC	Ant. Copper	5mm	1000	50.36

SHELF SUPPORT

With 5mm (3/16") steel pivot pin. Plastic coated.

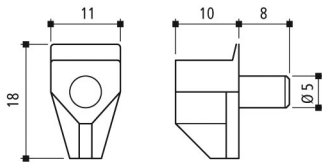

Clear



White

Code	Color	Ctn	List
HD161.549.30	Clear	1000	\$ 8.34 /C
SC5MM-CL	Clear	100/bg	10.20 /bg
SS23-WH	White	5000	88.66 /M

SWEDISH TYPE SHELF SUPPORT

Insert into pre-drilled holes; the shelves are then simply put on the supports, or kerfed to slip over supports.
 Dia: 3mm. Length: 8.82".
 Galvanized steel wire. 100 per box.



282.71.712 List \$ 51.05/C

PLUG-IN SPOON-SHAPED SHELF SUPPORTS

Steel Stud in 5mm or 1/4" Pins



Nickel



Black



Brass



Antique Copper

Pack: 100 each.

Code	Finish	Pin	List/C
SC5MM-PB	Brass	5mm	\$ 12.02
SC5MM-NI	Nickel	5mm	10.79
1306BK	Black	5mm	19.75
2306AC	Ant. Copper	5mm	12.28
SC14-PB	Brass	1/4"	10.40
SC14-NI	Nickel	1/4"	10.98

KV 333 SUPPORT



333KV

Steel, Bright Zinc Plate.

Pin Dia: 7/32"; use 15/64" diameter drill.

Pin Length: 1/2", Shelf Rest - 9/16" W x 7/16" L

Code	Ctn	List/ea
333KV	1000	\$.60

PLUG-IN SHELF SUPPORTS



Brown



White

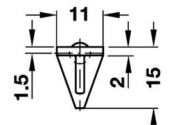
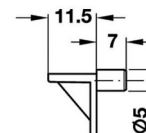

Plastic shelf support with a grooved 5mm stud.
 (sizes are in mm).

Code	Finish	Ctn	List/C
283.63.117	Brown	500 ea.	\$ 5.23
283.63.715	White	500	6.61



SHELF SUPPORTS

BAINBRIDGE PLASTIC SHELF CLIPS

Tan
FlutedWhite
Smooth

Pin Dia: 1/4" or 5mm
Pin Length: 11/32"
Smooth or Fluted Stem
Ctn. Qty: 10,000 each

1811 - 1/4" Diameter Pins

Code	Color	Stem	List/M
1811FL	Tan	Fluted	\$ 100.78
1811FC-50	Clear	Fluted	97.30
1811WH	White	Smooth	124.48
1811-	Tan	Smooth	93.06

3811 - 5mm Diameter Pins

Code	Color	Stem	List/M
3811T-50	Tan	Smooth	\$ 75.75
3811C-50	Clear	Smooth	78.48
3811W-50	White	Smooth	100.67

HETTICH SHELF SECURING STUD

With pivot for 5mm (3/16")
holes. Made of translucent
plastic.

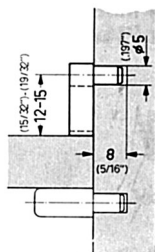

Code	Ctn	List/C
1005082	1000	\$ 8.75

EARTHQUAKE CLIPS

Load Rating: 80 lbs. Pin Diameter: 5mm,
Pin Length: 8mm. Overall: 2-1/4" L x 3/4" W
Pack: 2500 each

Code	Shelf	Color	List
50536*	5/8"	Clear	\$ 14.51/C
50531*	5/8"	White	83.13/M
50636*	3/4"	Clear	147.61

*disc when out

EARTHQUAKE CLIPS

EARTHQUAKE CLIP

Tenn-Tex

#T-803 -- Clear

Load Rating: 300 lbs.
Double pins are 5mm dia
x 10mm L
C to C = 32mm
Overall: 2-1/2" L x 1-1/8" W

For 3/4" or 1" shelves.
Shelf cut size: Inside cab width
minus 6mm.



T-803

Code	Ctn	List/ea
T-803	1000 ea.	\$.60

EARTHQUAKE-PROOF SHELF SUPPORT



02.7875.104

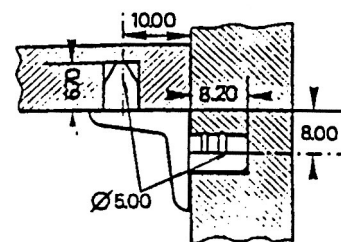

The two 5mm posts on nickel plated Zamac shelf
support keep shelves from sliding in the event of an
earthquake.

Code	Ctn	List/C
02.7875.104	100 ea.	\$ 24.43

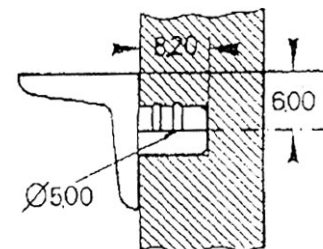

02.7879.104

Non-Seismic
Version

Nickel plated with one 5mm peg.

Code	Ctn	List/C
02.7879.104	100 ea.	\$ 23.51



SHELF SUPPORTS

REV-A-SHELF LOCKING SHELF CLIP



Height: 2-1/4"
Depth: 5/16"

Available for 3/4" (305-34)
and 5/8" (305-58) shelves.

5mm pins.

Polymer locking shelf clip with 5mm pin.
Bulk pack: 1000, Sold per 100 each.

Code	Size	Finish	List/C
305-34-0010-1	3/4"	White	\$ 17.34
305-34-0020-1	3/4"	Clear	17.34
305-58-0010-1	5/8"	White	17.34
305-58-0020-1	5/8"	Clear	17.34

LOCKING SHELF SUPPORTS

Locking shelf support with
2 each 5mm pins.
White in color.



3227W - 3/4"
3228W - 1"

Pack: 2500/Ctn.

Code	Shelf	C/C of stems	List/C
3227W-50	3/4"	1-1/4"	\$ 66.57
3228W-50	1"	1-1/4"	53.67

Locking shelf support in
5mm or 1/4" dia. pins.
White in color.



3226W - 5mm
3236W - 1/4"

Pack: 1000/Ctn.

Code	Shelf	Pin	List/M
3226W-30	3/4"	5mm	\$ 101.89
3236W-30*	3/4"	1/4"	91.30

*disc when out

SHELF SUPPORTS FOR GLASS SHELVES



282.23.716

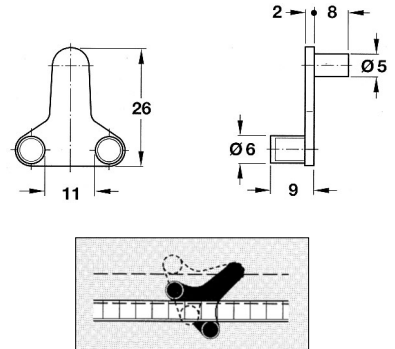

These shelf clamp supports are for glass shelves from
6-10mm thick. Mount glass on top of or between the two
projecting supports. Clamping pins have a plastic coating.
Shelf pin fits a 5mm hole. Zinc die-cast, nickel plated.

Code	Description	Ctn	List/ea
282.23.716	Glass Shelf Support	10 ea.	\$ 1.82

GLASS SHELF PIN

Glass Shelf Pin, 3/16" hole (5mm).
Overall length: 17mm.



MP-GC
5mm

Code	Ctn	List/M
MP-GC	1000	\$ 93.88

SHELF PINS



#FT58370

Duplo Pin
5mm x 16mm

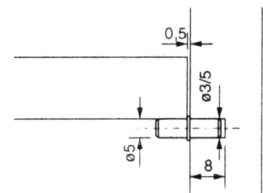

#FT58341

Straight Pin
5mm x 25mm

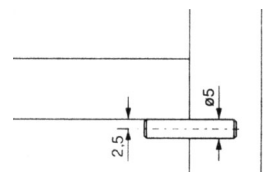

Code	Description	Ctn	List
FT58370	Duplo Pin, Zinc	100 ea.	\$ 29.17/ M
FT58341	Straight Pin, Nickel	100	8.38/ C



SUPPORT BRACKETS

GRANITE COUNTER SUPPORTS

Rockford Process Control

Granite Counter Support Brackets support the overhang on Granite top Islands and bars without corbels or other visible support.

A pair of brackets support up to 300 lbs. when mounted correctly. Heavy Duty brackets will support up to 500 lbs. Drilled for countersunk screws up to #14 flat head. Material: Plate Steel, Black finish. 3.5" Widths and 12", 16", 24" and 30" lengths.



GCS-12 thru 24, GCS-12-HD thru 24-HD

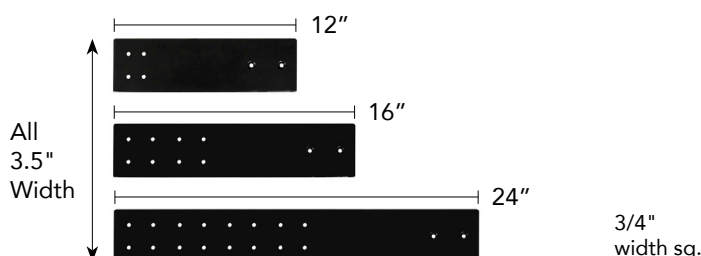

GCS-30-HD



Installation

Attach support studs to the top of cabinets at the back panel and where the end of the support bracket falls. Rout a dado so bracket is flush with bottom of countertop and top of stud. Attach bracket to studs using min of four screws with a 1.5" min length. A min of 1/3 of the bracket must be mounted inside the cabinet. The countertop must rest on the Support Bracket. Brackets should be mounted every 16". Overhang beyond the Bracket should not exceed 6". Check with the counter manufacturer for their overhang recommendations. Apply adhesive to both the counter top and the Support Bracket when mounting the counter top.

Code	Description	Thk	List/ea
GCS-12	Counter support, 12"	3/16"	\$ 15.41
GCS-16	Counter support, 16"	3/16"	20.15
GCS-24	Counter support, 24"	3/16"	30.05
GCS-30	Counter support, 30"	3/4"	25.03
GCS-12-HD	HD Counter support, 12"	1/4"	\$ 17.61
GCS-16-HD	HD Counter support, 16"	3/8"	33.87
GCS-24-HD	HD Counter support, 24"	3/8"	49.99
GCS-30-HD	HD Counter support, 30"	3/8"	59.44

SPEEDBRACE T-BRACE

FastCap



Fastcap T-Brace is the perfect way to create the illusion of a free floating shelf that is strong enough to support over 300 lbs. per pair. Ideal for new construction, but can be used in a remodeling application when an access hole is cut in the drywall for attachment.

Black finish, 5" x 3/4" thick.
Available in 11" and 16" lengths.

Features

- 1/4" to 3/8" steel
- Mounting holes on both sides
- 300 lb. capacity per pair

Great For

- Floating shelf
- Floating mantels

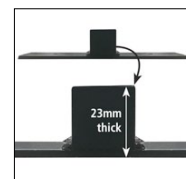
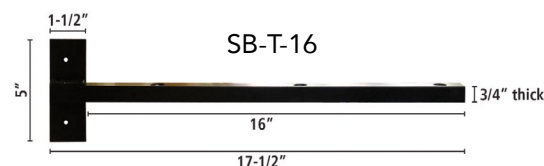
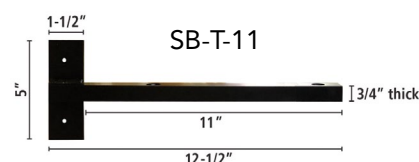

Use vix or hinge bit to center holes

Pack: 10 each.

Code	Description	List/ea
SB-T-11	T-Brace, 11" Black SpeedBrace	\$ 51.48
SB-T-16	T-Brace, 16" Black SpeedBrace	64.35

SUPPORT BRACKETS

SPEEDBRACE "STEALTH"
FastCap



Nearly invisible when installed



12" & 16" mounted on pony wall
24" mounted on double bracing

The Stealth Speedbrace supports your countertop and bar overhangs with no visible kicker or expensive corbels. A pair of braces will support 300 lbs. of weight. Sold individually.

- Features
- 3/16" Steel, 3-1/2" wide
- Black Finish
- Countersunk screwholes
- Great For:
- Countertops
- Bars
- Extra Bracing

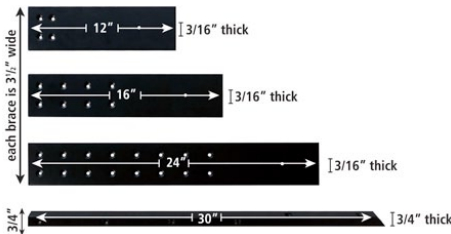

30" size fastens to Inside Cabinets



30" Length x 3/4" Thick

Table with 3 columns: Code, Description, List/ea. Rows include SB-12BL (12 inch Black Speedbrace), SB-16BL (16 inch Black Speedbrace), SB-24BL (24 inch Black Speedbrace), and SB-30BL (30 inch Black Speedbrace).

SPEEDBRACE "STEALTH" HD
Heavy Duty

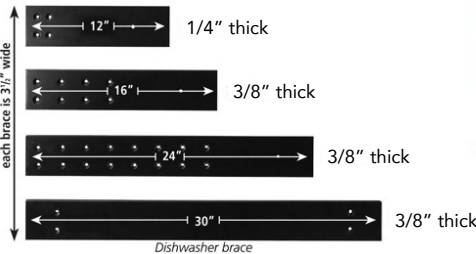

Heavy duty version of the "Stealth" Speedbrace. A pair of HD braces will support 500 lbs. of weight. 12" is 1/4" thick. 16", 24" and 30" are 3/8" thick. All 3-1/2" wide. Black finish. Sold individually.

Table with 3 columns: Code, Description, List/ea. Rows include SB-12HD (12 inch Heavy Duty Speedbrace), SB-16HD (16 inch Heavy Duty Speedbrace), SB-24HD (24 inch Heavy Duty Speedbrace), and SB-30HD (30 inch Heavy Duty Speedbrace).

SPEEDBRACE ISLAND
Heavy Duty

The Stealth Island SpeedBrace supports your island countertops and bar overhangs with no visible kicker or expensive corbels. A pair of Island SpeedBraces will support 500 lbs. of weight. 3/8" thick steel, black finish. Sold individually.



Easy to install

- Great For:
- Island Countertops
- Bars
- Extra Bracing

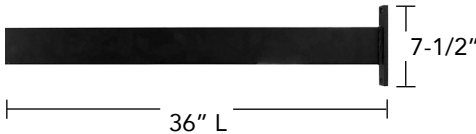

Table with 3 columns: Code, Description, List/ea. Row includes SB-36BL (36 inch Black SpeedBrace Island).



SUPPORT BRACKETS

HYBRID BRACKETS

Surface or Concealed Mounting

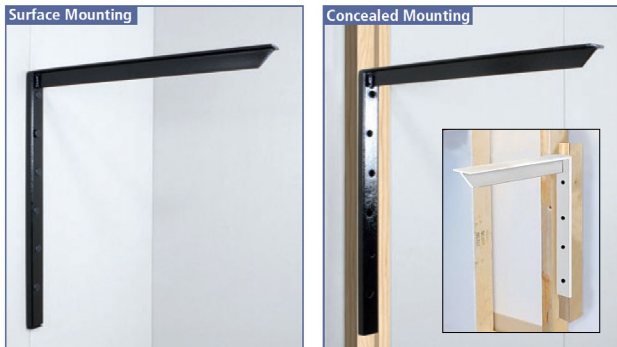

Features

- Surface mount or concealed mounting for floating shelf appearance
- Mounts with screws (faster)
- Black or White powder coated finish
- Non-handed
- Plastic finishing caps included for surface mounting
- **Allows room for plumbing/electric**

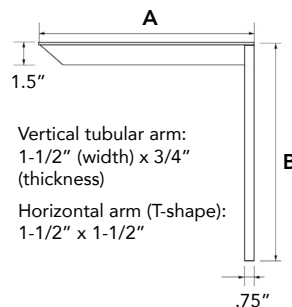

Surface mount



Plastic finishing caps that conceal the bottom of tube (2) and the screw holes (1) are included.

Concealed mount



Concealed applications require ripping a 2" x 4" lengthwise, and mounting it (2) to the side of a standard 2" x 4" stud (1).

Hybrid Brackets / 2 per Carton, sold per each.

Code	(A) Support Arm	(B) Height	Load Cap (pair)	List
HYB-12BL	12"	12"	2050 lbs.	\$ 56.88
HYB-12WH	12"	12"	2050	47.40
HYB-18BL	18"	18"	1780	71.28
HYB-18WH	18"	18"	1780	71.28
HYB-24BL	24"	24"	1360	85.83
HYB-24WH	24"	24"	1360	86.62

Order screws separately.

CONCEALED WORK STATION BRACKETS

Mount to stud for extra strength

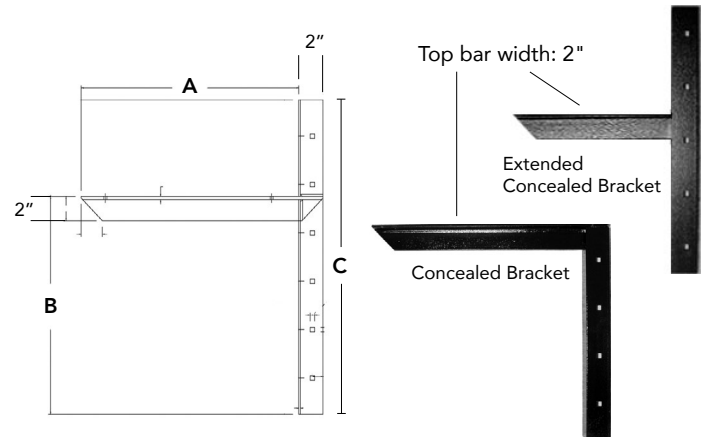

- Steel Construction
- Load limit range of 1,800 to 4,500 lbs. per pair
- Mounting hardware included
- All welds on reverse for easy, clean install
- Black in Color



This Island was made using Extended Concealed and Concealed brackets



Extended Concealed brackets used to create a floating shelf



This picture shows the installation of the Extended Concealed Bracket behind drywall and how it looks when the drywall is installed overtop

Code	A	B	C	Weight Cap / pr.	List/ea
C18-BL	18"	18"	-	2,060	\$ 75.83
C24-BL	24"	18"	-	1,800	88.42
EC-18BL	18"	18"	26"	4,500	83.91
EC-24BL	24"	18"	26"	2,320	88.33



SUPPORT BRACKETS

WORK STATION SUPPORT BRACKETS

For Countertops, Desktops and Table Supports



- 1000 lb Load
- 11 Gauge Steel (1/8" thick)
- Weight Limit Exceeds 1000 lbs/pr.
- 1-1/2" Forms with 1/4" Holes
- Two Colors, Five Sizes

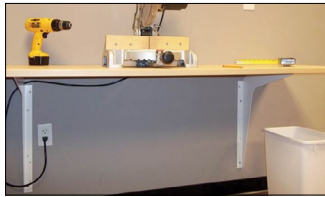

Code	Size	Color	Ctn	List/pr
812BL	8" x 12"	Black	5 pr.	\$ 28.97
812WH	8" x 12"	White	5	33.05
1218BL	12" x 18"	Black	3	78.13
1218WH	12" x 18"	White	3	57.63
1521BL	15" x 21"	Black	3	65.72
1521WH	15" x 21"	White	3	53.61
1824BL	18" x 24"	Black	3	89.98
1824WH	18" x 24"	White	3	89.98
2429BL	24" x 29"	Black	2	89.80
2429WH	24" x 29"	White	2	89.80

PHILLIPS PAN HEAD TYPE 17 SCREWS

Quickscrews

12-8 X 3/4" Phillips Pan Head Coarse Thread Type 17 Zinc Plated Screws.

Can be used with Heavy Duty Workstation Support Brackets and the Heavy Duty Speed-brace Stealth Brackets.



Code	Description	Ctn	List/C
9807	# 12-8 X 3/4" Phillips Pan Head	100	\$ 6.47

KV 206 FOLDING L-BRACKET

Heavy Duty

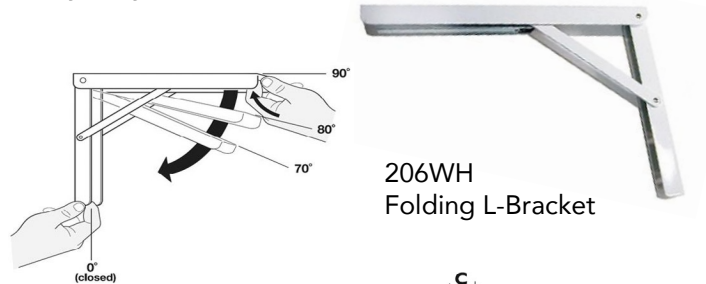

Dimensions:

Size	A	B	C
12"	11.8"	7.9"	.6"
16"	15.75"	10.6"	.8"

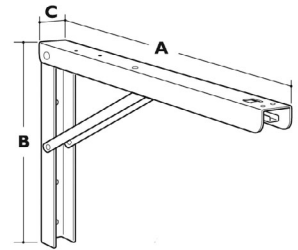

- For 12" to 24" Deep shelving
- Can be mounted to any type of wall
- Adjustable to 4 positons: 90°, 80°, 70°, and 0° (closed position)
- Durable zinc-coated steel construction with spring-loaded release lever
- Exceeds BHMA static load testing requirements
- Load Rating: 12" - Up to 770 lbs/pr
16" - Up to 880 lbs/pr

These sturdy folding L-brackets allow you to create a worksurface that can be quickly folded out of the way when no longer needed. The KV 206 bracket's convenient one-hand release mechanism makes the bracket easy-to-open, close, or adjust without the danger of getting hands caught in a folding crossbar.

Code	Description	Ctn	List/ea
206WH12	12" White Folding Brkt	10	\$ 35.44
206WH16	16" White Folding Brkt	10	98.01

SHELF BRACKETS

KV HEAVY DUTY SHELF BRACKET



208WH

Holds up to
1000 lbs/pr.

Holds up to 1000 lbs. per pair when mounted per manufacturer recommendations. 5mm thick steel bar construction. White epoxy coated finish. Recommended fasteners (not included) are 3" or longer x 5/16" lag screws mounted into studs. Attach shelf using a #8 or larger round-head wood screw.

<u>Code</u>	<u>Height x Length</u>	<u>Ctn</u>	<u>List/ea</u>
208WH300	8.3 x 11.6"	10 ea.	\$ 12.53
208WH400	10.6 x 16.6"	10	14.88
208WH500	12.9 x 19.5"	10	16.90
208WH550	14.2 x 21.7"	10	20.22

SUGATSUNE
FOLDING BRACKET

Stainless Steel

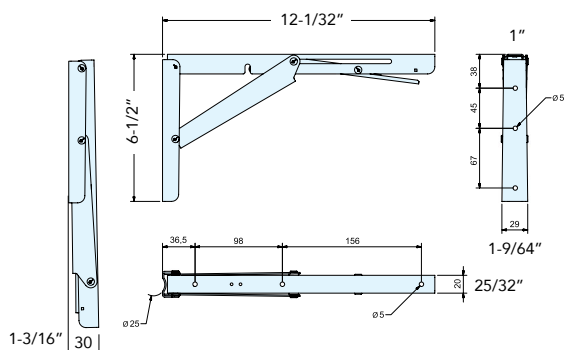

- Automatically locks when flap is in opened position
- Depress lever to release the lock
- Bracket with hinge function in one unit

<u>Code</u>	<u>Finish</u>	<u>Load cap</u>	<u>Ctn</u>	<u>List/ea</u>
EB-303EP	Pol. Stainless Steel	330 lbs.	25	\$ 43.25

FOLDING SHELF BRACKET

Parker

1794

This folding steel shelf bracket is ideal for folding tables, work surfaces, book shelves or anywhere a foldaway shelf is required. 110 lb. load rating per pair.



Locks automatically in open position. Gray enamel finish.

<u>Code</u>	<u>Size</u>	<u>Ctn</u>	<u>List/pr</u>
1794-8	8" x 8"	12 pr.	\$ 20.16
1794-12	12" x 12"	6	27.55
1794-16	16" x 16"	6	37.87

FOLDING SHELF BRACKET

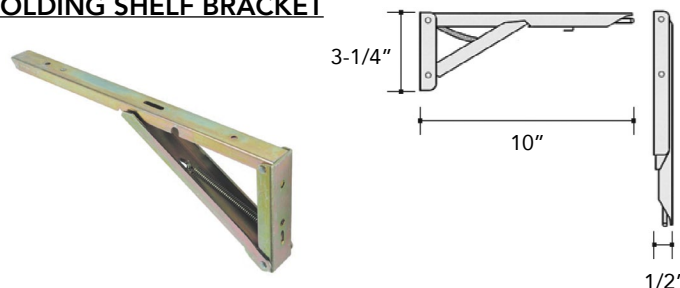

Hinged spring brackets are especially suitable for extending tables or worktops. Locks into upright position automatically. Light pressure on release button allows fold-down positioning. Steel, yellow chromated finish. 88 lbs per pair weight capacity. Use 2 each #10 and 3 each #6 panhead screws (not provided) to install.

<u>Code</u>	<u>Description</u>	<u>Ctn</u>	<u>List/ea</u>
FT65795	10" Steel Folding Shelf Bracket	10 ea.	\$ 23.88

NON-ADJUSTABLE SHELF BRACKET

Parker

Gray enamel finish,
24 each/box. Screws not included.

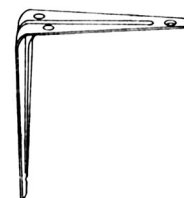

<u>Code</u>	<u>Size</u>	<u>Ctn</u>	<u>List/ea</u>
1785	5" x 6"	24 ea.	\$ 1.27
1788	8" x 10"	24	1.78
1792	12" x 14"	24	4.84

FLOATING SHELVES

CONCEALED FLOATING SHELF BRACKETS

Concealed, Heavy Duty

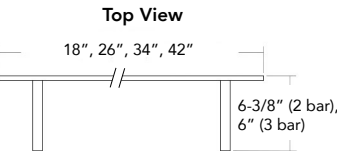

With elongated screw holes for greater adjustment.



Fits Hollow & Solid Floating Shelves

- 1/4" thick steel black bar
- Supports shelves 2" thick or more and from 7" to 14" deep
- 45 lbs. capacity per rod
- Elongated screw holes
- Rods are set 2" C/C from each end, 3/4" dia, and countersunk screw holes are 3/16" OD



2 Rod	<u>Length</u>	<u>Load Cap</u>	<u>List/ea</u>
1806BL-2	18"	90 lbs.	\$ 122.93
2606BL-2	26"	90	153.96
3 Rod			
3406BL-3	34"	135	178.62
4206BL-3	42"	135	207.53

* Does not include shelf or screws

CONCEALED FLOATING SHELF BRACKETS

Made in USA

Concealed Med & Heavy Duty Brackets



Fits Hollow Slabs, Solid Beams & Aproned Surfaces



- Up to 18" (MD), 24" (HD) Deep & Any Length
- Supports mantel, shelves and desks from 9" to 24" deep
- Fits materials 1-1/2" to 4" thick
- Steel mounting plate is 1/4" thick x 12" long x 3" wide and mounts to side of stud

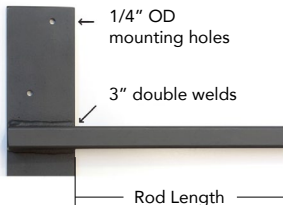
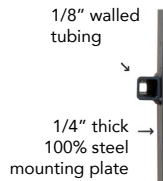

- Screw holes are 1/4" OD, ideal for high strength 1/4" lag bolts

<u>Code</u>		<u>Rod Length</u>	<u>Load Cap</u>	<u>List/ea</u>
3406BL	Med Duty	6"	68 lbs.	\$ 61.20
3410BL	Med Duty	10"	55	73.37
3414BL	Med Duty	14"	50	84.70
3416BL-HD	Heavy Duty	16"	70	115.00
3420BL-HD	Heavy Duty	20"	60	125.00

* Does not include shelf or screws

FLOATING SHELVES

Create an elegant and clean style in your space. Easy to install and lightweight design - expand your storage space while adding a fresh modern touch.

Stocking 5 sizes in an unfinished maple veneer with maple edging.

Includes 1 shelf and 1 mounting bracket.



All Floating Shelves 2" Thick & 11-5/8" Deep

<u>Code</u>	<u>Description</u>	<u>Load Cap*</u>	<u>List/ea</u>
FS240-MA	Maple Shelf, 23-3/4" W	20 lbs.	\$ 226.50
FS300-MA	Maple Shelf, 29-3/4" W	25	234.18
FS360-MA	Maple Shelf, 35-3/4" W	30	259.46
FS420-MA	Maple Shelf, 41-3/4" W	35	272.46
FS480-MA	Maple Shelf, 47-3/4" W	40	296.00
FS600-MA	Maple Shelf, 59-3/4" W	50	392.68

* Weight ratings are based on loads being evenly distributed over the shelf.



FLOATING SHELVES

FLOATING SHELF BRACKET

FS-BR

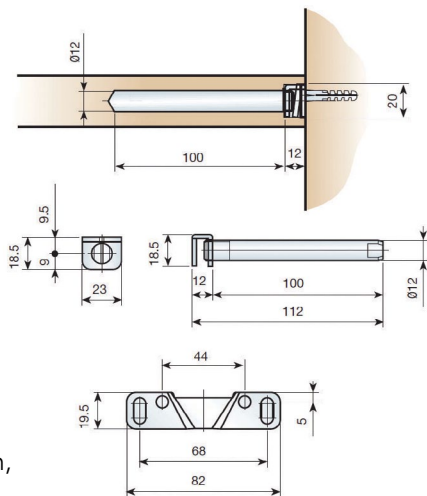
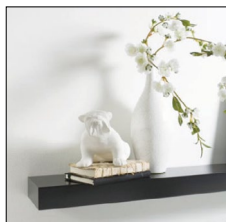

Up to 8" Shelf Depth,
Load Cap: 37.4 lbs.
per pair of brackets*

Up to 12" Shelf Depth,
Load Cap: 25.3 lbs.
per pair of brackets*

* Based on 35" Length shelf with 2 brackets.

For every 18" additional length, add 1 additional bracket.

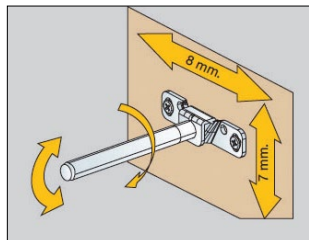

Oval holes allow accurate leveling. It can be horizontally adjusted +/- 5° by moving the rod along the support.

The 90° angle may be easily adjusted +/- 5° just by turning the rod.

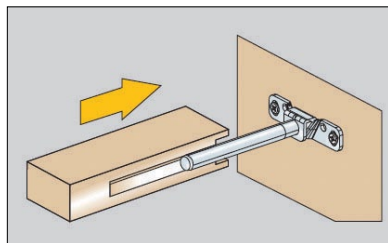

Place the shelf in position. This can subsequently be removed whenever necessary to carry out further adjustments.

Each bag contains:

1 support, 4 plastic wall plugs, and 4 screws.

Code	Description	Ctn	List/bg
FS-BR	Floating Shelf Bracket	25 bgs.	\$ 9.52

FLOATING SHELF BRACKETS

Innovashelf

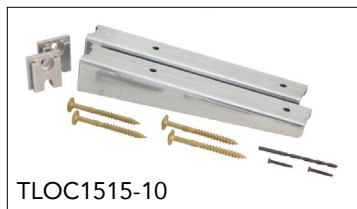

TLOC1515-10



- Designed for shelves 2" thick or more
- 2 piece design for easy installation in wood studs
- Wood stud weight rating 300 lbs per pair of brackets
- Includes all hardware to mount and secure shelves
- Easy adjustability during and after installation

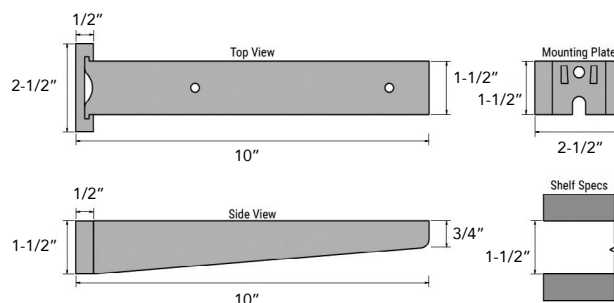

Code	Description	List/pr
TLOC1515-10	10" Floating Shelf Bracket	\$ 100

FLOATING VANITY BRACKETS

Innovashelf



FVB-1521

- Available in kits for vanities 15 - 84" wide
- Width easily adjusts to accommodate any size cabinet
- Compatible with hardwood, plywood, MDF and particle-board cabinets

Code	Min-Max Vanity O/A Width	Load Cap	List/st
FVB-1521	15 - 21"	500 lbs.	\$ 120
FVB-2129	21 - 29"	500	140
FVB-2942	29 - 42"	1000	164
FVB-4256	42 - 56"	1000	185
FVB-5684	56 - 84"	1000	214

SUPPORTS

OMEGA SUPPORT BRACKETS

Pack: 2 brackets, Full Cartons Only



S1101 Support Bracket
10" Ht x 2" W x 8" Depth

S1102 Support Bracket
8" Ht x 2" W x 6" Depth

Code	Description	List/ea
S1101MUF2	Maple	\$ 27.81
S1101QUF2	Alder	32.05
S1102MUF2	Maple	25.40
S1102QUF2	Alder	22.64

WALL CABINET HANGING SYSTEM

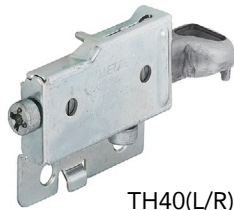

TH40(L/R)

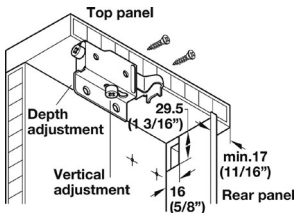

Suspension brackets are handed (left or right) and are 100% steel construction. They attach on the inside of each cabinet side panel, allowing the cabinet to be secured to the hanging rail. Suitable for medium duty (280 lb) use and require a cover cap.



Caps available in White, Black and Almond colors. Handed.



#875-Z1-24
Wall Mounted Hanging Strip, Galv. Steel. 2.5 meters (8'2")

Code	Description	Ctn	List/ea
TH40-L/R	Hanging Brackets (choose L or R)	200	\$ 5.45
TH40-AL-LH/RH	Cover cap, Almond	200	.95
TH40-WH-LH/RH	Cover cap, White	200	1.03
TH40-BL-LH/RH	Cover cap, Black	200	.95
875-Z1-24	Hanging Strip, Steel	10	16.93

CABINET HANGERS

ALUMINUM HANGING RAILS & CLIPS

Heavy Duty

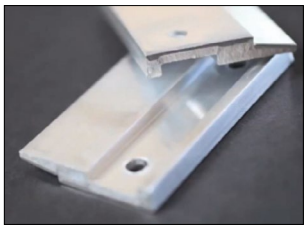
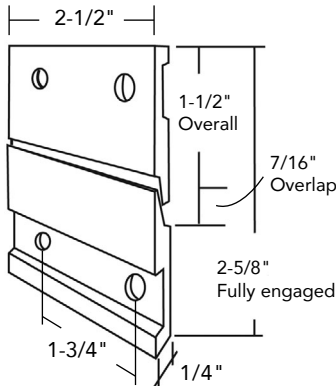

HC2 Clips - 2-1/2" width
Sold per pair

Two interlocked clips shown.

HC1 Rails
12' lengths,
No holes
Sold per each

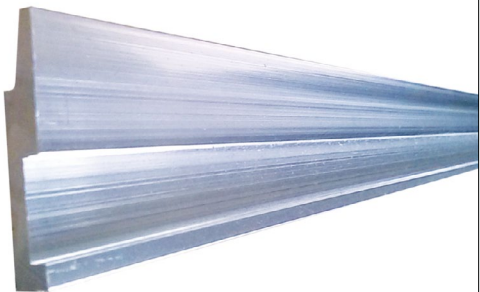

Excellent for hanging wall panel systems, elevator panels, cabinetry door displays, speaker panels, blind panels, secret panels, etc.

This aluminum extrusion provides a simple, secure and concealed installation. Provides easy panel removal for mechanical access, remodeling or refinishing. Clips are 2-1/2" wide, 1-1/2" high, with holes and sold in pairs. Rails are 144" (12') lengths, without holes and sold per each. Screws not included. Clip can use up to a #10 pan-head screw.

Clips allow slim 1/4" clearance, side to side adjustability and high load capacity.

Code	Description	Ctn	List
HC1	144" (12') Hanging Rail	10 ea.	\$ 55.42/ea
HC2	2-1/2" Hanging Clip	24 pr.	3.13/pr

**TV LIFTS****FLAT SCREEN TV LIFT**

Takes Flat Screen TVs up to 48"

Special Order Only

4050WR

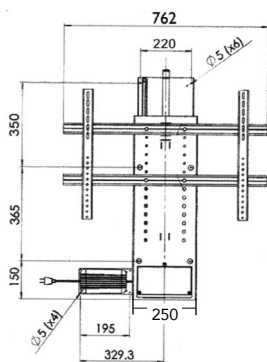

Total Travel: 29.5"

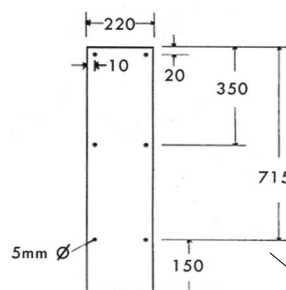
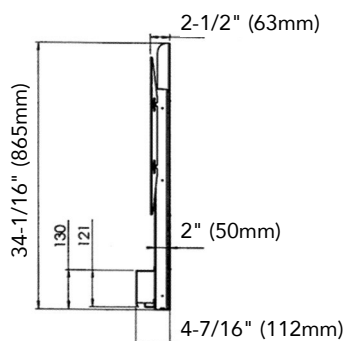
Back Panel
Mounting HolesOverall Extended Height: 58-1/8"
Unit Weight: 40 lbs.

Min. Height closed: 34-1/16"

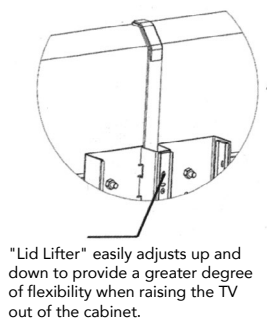
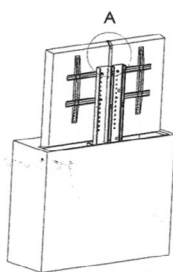
Weight Capacity:
145 lbs.**"Whisper Quiet"
Operation****"Lid Lifter"** easily adjusts up and down to provide a greater degree of flexibility when raising the TV out of the cabinet.

- High quality German Bosch motor for whisper quiet operation
- Ball-bearing guide system for added stability
- Requires only 2-3/4" of depth behind the TV
- Weight Capacity: 145 lbs.
- Can be easily mounted by one person in minutes using only a screwdriver
- Radio command remote control with manual override switch included.
- UL Listed, 34-1/16" Closed Ht.

Special Order Only

Code	Description	List/ea
4050WR	Flat Screen TV Lift	CALL

WHISPER RIDE 1000

For 50" to 70" Flat TVs

Special Order Only

WR1000

For 50" to 70" TVs

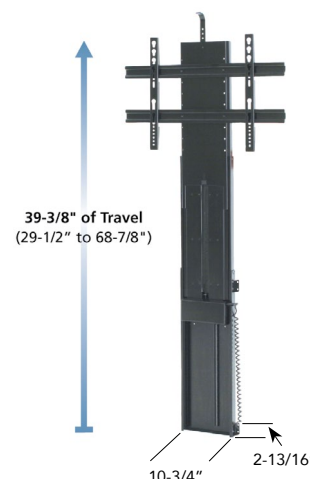

Min. Height closed: 29-1/2"

**Features**

- Quiet operation, 1.1"/sec
- Rack and pinion design with unique stability system
- Reverse safety function
- Requires only 2-13/16" depth behind the TV
- Weight capacity: 145 lbs.
- 39-3/8" of travel
- Simple and fast mounting
- IR remote available
- Anti-pinch safety protection
- UL listed power supply

**Complete inside
one carton:**Code
WR1000List
CALL

- Remote control (RF)
- Manual push switch
- Adjustable lid lifter
- Plug and play assembly
- Universal TV mounting bracket

Special Order Only



Luxe

High Gloss Custom Door & Drawer Fronts

LUXE is an advanced decorative panel with a high gloss finish on one face, while the back is a matching decorative matte melamine in the same design.



- 3/4" MDF Core
- High Gloss Polyester Front / Matte Back
- Two Edgebanding options (solid and bi-color)
- Separate edgebanding & boards available

This product is more durable than alternative products; highlighting its scratch-resistance, surface quality, high brightness as well as light stability towards colors.

These qualities make it well suited for vertical applications in kitchen, bathroom, office and home furniture.

14

The LUXE manufacturing process allows solid colors plus a wide range of designs, such as wood, marble, stone, fantasy etc. This makes LUXE a highly versatile and decorative product.

Can be supplied in panels or in edged pieces. For this last option, LIOHER uses PUR technology in order to offer its product the finish according to its quality.



Luxe Doors & Fronts

List

Colors & Patterns

\$ 23.94 / sq ft.



See all colors and
patterns next page



High Gloss Custom Door & Drawer Fronts Colors and Designs

Solids

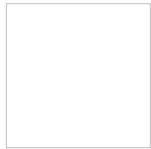

Blanco

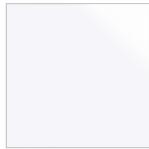

Blanco Polar

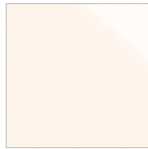

Magnolia



Gris Perla



Gris Nube



Gris Metallic

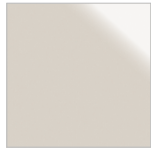

Cashmere



Basalto



Gris Plomo



Azul Marino



Azul Indigo



Antracita



Agua Marina



Verde Salvia

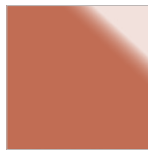

Cotto



Rojo



Curry



Black

Patterns

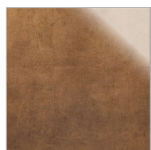

Cuzco Oro

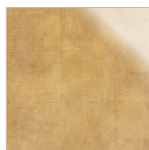

Cuzco Royal Gold

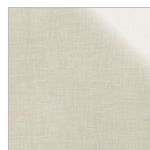

Textil Plata

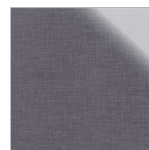

Textil Grafito



Roble Frappe



Olivo

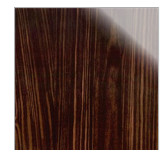

Guayana

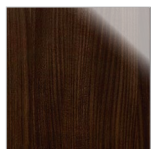

Olmo



Nogal Rosales 02

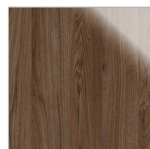

Nogal Rosales 03

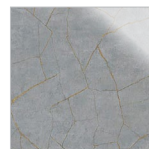

Porcelain 01 Gold



Porcelain 02 Gold

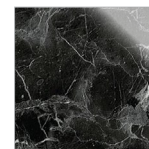

Oriental Black

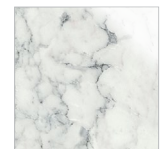

Oriental White



Blanco
Pearl Effect

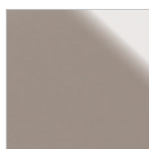

Basalto
Pearl Effect

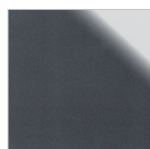

Antracita
Pearl Effect



Metallo 1

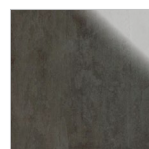

Metallo 2

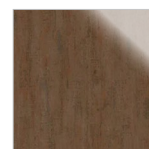

Metallo 3



Metallo 4



Synchron structured panel LINE

Textured Melamine Panels Door & Drawer Fronts



SYNCRON STRUCTURED PANELS gives a natural and highly decorative texture to panels, door fronts and drawer fronts.

- Textured Melamine Front
- 3/4" Particle Board Core
- Includes matching edgebanding on cut to size pieces
- Cabinets, furniture, interior decorative projects
- Grain matching (sequenced) available at an extra cost

Synchron Doors & Fronts

List

Textured

\$ 15.83 / sq ft.

Natural Wood



Blanco
Natural Wood

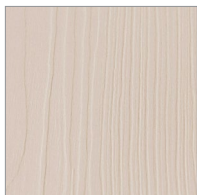

Cashmere
Natural Wood

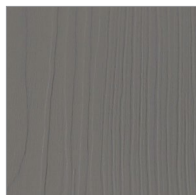

Gris Plomo
Natural Wood

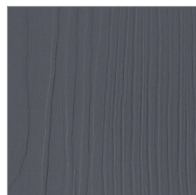

Antracita
Natural Wood

Évora



Évora 3



Évora 4

Roble Muratti



Roble
Muratti 4

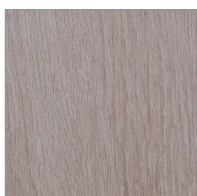

Roble
Muratti 1



Roble
Muratti 2



Roble
Muratti 3



Roble
Frappé 1



Roble
Frappé 2



Roble
Frappé 3

Roble Frappé



Olmo



Olmo 1



Olmo 2



Olmo 3

Ida



Ida 1



Ida 2



Ida 3



Ida 4

Ice Cream



Ice Cream 1



Ice Cream 2



Ice Cream 3



Ice Cream 4

Woodline



Woodline 01



Woodline 03

Lakeland Oak



Lakeland Oak 1

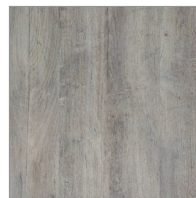

Lakeland Oak 2



Lakeland Oak 3

Nocce

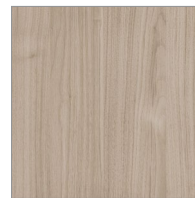

Nocce 1

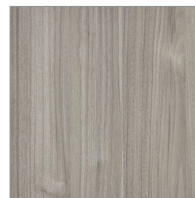

Nocce 2



Nocce 3

Anniversary Oak



Anniversary Oak 1

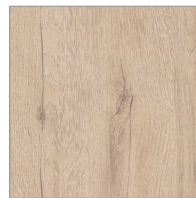

Anniversary Oak 2



Anniversary Oak 3

Como Ash



Como Ash 1

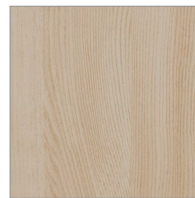

Como Ash 2



Como Ash 3

Oxid



Oxid 1



Oxid 2



Oxid 3

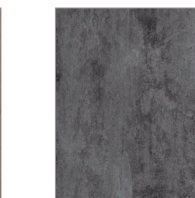

Oxid 4

Carolina



Carolina Pine Sierra

Zenit

Supermatt High Resistance Surface Door & Drawer Fronts



Beauty is not always delicate - meet the toughest matte design boards. In contrast to the Luxe lacquered panels, Zenit offers a deep, super matte finished panel with a silky soft feel and excellent resistance to abrasion. Recommended for use in the manufacture of all kinds of furniture and decorative products.

The Zenit collection comes in a complete range of solid colors, with or without metallic particles (Supermatt or MetalDeco), and elegant designs such as the marbles. These designs provide a more subtle, yet sleek look for modern kitchens, bath and home furniture as well as in interior design and commercial projects.

Supermatt

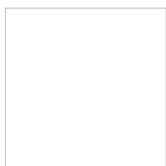

Supermatt
Blanco

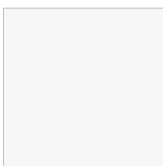

Supermatt
Blanco Polar

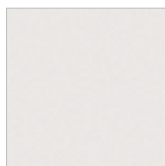

Supermatt
Gris Perla

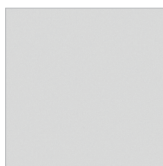

Supermatt
Gris Nube

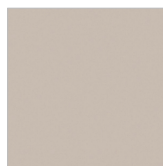

Supermatt
Cashmere



Supermatt
Basalto



Supermatt
Gris Plomo



Supermatt
Agua Marina



Supermatt
Azul Indigo



Supermatt
Azul Marino



Supermatt
Antracita

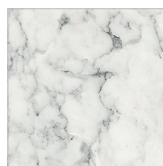

Supermatt
Oriental White

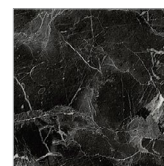

Supermatt
Oriental Black



Supermatt
Black



Supermatt
Cotto

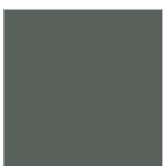

Supermatt
Verde Salvia



Supermatt
Tortora



Supermatt
Titan 01



Supermatt
Titan 03

Metaldeco



MetalDeco
Blanco SM



MetalDeco
Antracita SM

Zenit Doors & Fronts

List

Colors & Patterns

\$ 23.94 / sq ft.



MetalDeco
Basalto SM



CAVA

DOORS

Traditional Solution & Advanced Technology

CAVA DOORS are designed to marry the traditional look with the advanced surfaces of ZENIT and SYNCRON. Available in 3, 5, 7 and 9 piece doors.



Cava Doors	List
Cava Zenit	\$ 34.66 / sq ft.
Cava Synchron	27.33 / sq ft.



Blanco Supermatt
Cava



Basalto Supermatt
Cava



Muratti 1 Texture
Cava



Ida 3 Texture
Cava



Frappe 3 Texture
Cava

Finger-Pull

Integrated handle

14

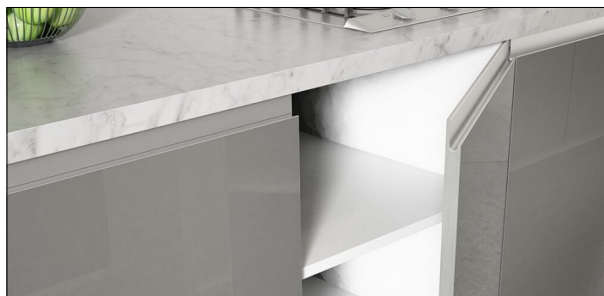

The Finger-Pull "J profile" provides modern aesthetics and ergonomics, perfectly adapted to the minimalist trends and straight lines the current market demands.



Blanco



Olmo 3



Frappe 1



Muratti 1

Finger Pulls	List
Luxe J-Pull	\$ 34.29 / sq ft.
Synchron J-Pull	30.79 / sq ft.
Zenit J-Pull	34.29 / sq ft.



NORTHERN CONTOURS Cabinet Doors and Drawers

Northern Contours is the largest U.S. manufacturer of thermofoil cabinet doors and accessories. All orders are custom made and drop-shipped to the cabinet-maker within a 10 day lead time.

Find the perfect door style with Northern Contours' extensive selection of contemporary, transitional and traditional thermofoil cabinet doors and drawer fronts. 1-piece components are available in any of the standard thermofoil offerings including the latest in print technology with a variety of realistic woodgrains, textures, high gloss, and satin foils.

Go to www.northerncontours.com to see all available series, profiles, materials and finishes. The following are just a few examples.



Thermofoil Cabinet Doors and Drawer Fronts

Contemporary Series

Cortina



Elegante II

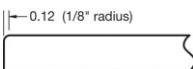

Italia II



Novara

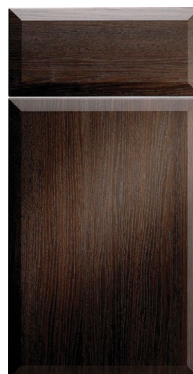

Turino

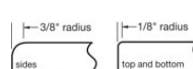
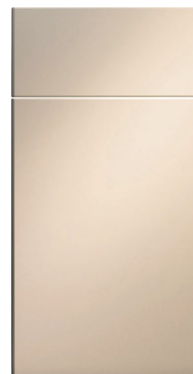

Shaker Series

Shaker

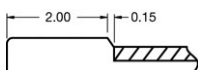

Lancaster

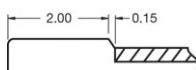
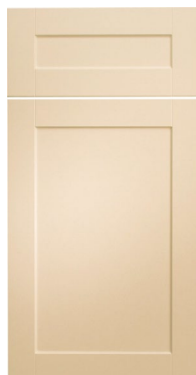

Lancaster Elite

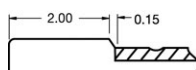
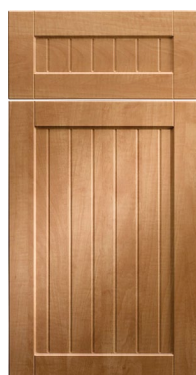

Bradford

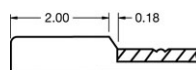
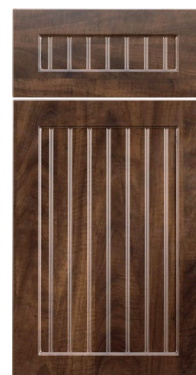

**NORTHERN CONTOURS Cabinet Doors and Drawers cont.****LEVEL Doors and Drawer Fronts**

For fresh modern designs, look no further than LEVEL, a series of flat laminated and edgebanded doors. Ultra high gloss acrylic, heavily textured melamine and the latest in linear and matte thermofoils along with 4 different edgebanding options offer you endless design combinations.

Go to www.northerncontours.com for a full materials listing.

**3DL Thermofoil**

Thermofoil on the face with a melamine back. ABS/PVC edgebanding options include Matching, 3D Aluminum, or Steel Gloss.

Entire thermofoil line of accessories is available including frame doors, mouldings, valances, fillers, overlays, Norlam, PSA and cut to size panels in various thicknesses.

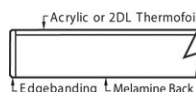
Acrylic and Wired

Ultra high gloss acrylic on the face with a melamine back. ABS edgebanding options include Matching, 3D Aluminum, Steel Gloss, or 2-Part (on White, Black, Ruby Red, Glass Green and Dark Grey).

Accessories are limited to overlays, cut to size panels, Norlam and PSA.

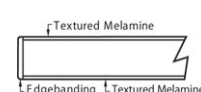
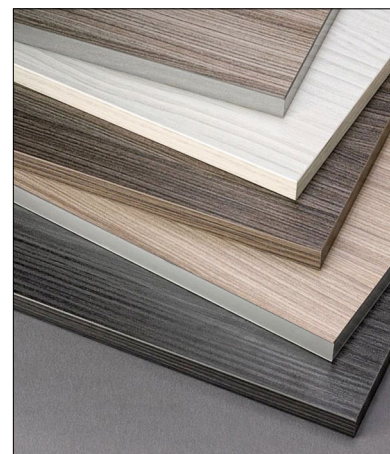
Impressions

Textured melamine on the face and back. ABS edgebanding options include Matching, 3D Aluminum, or Steel Gloss.

Entire thermofoil line of accessories is available including frame doors, mouldings, valances, fillers, overlays, Norlam, PSA and cut to size panels in various thicknesses.

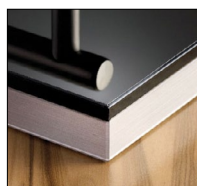
14**Edgebanding Options**

2 Part



3D Aluminum



Matching



Steel Gloss



EFI Aluminum Frames for Cabinet Doors



- Doors ship fully assembled
- Quick delivery
- Tempered safety glass
- No minimum orders
- Made in the USA
- Multiple glass types available

All Special Order:

4 weeks of production,
1 week of shipping.

Expedited service available:
2 weeks of production.

Profile Finishes:

- Clear Anodized Aluminum
- Stainless
- Polished
- Powder coating:
 - White
 - Black
 - Dark Bronze
 - Charcoal



Frame Profiles 4mm inserts

1505 (Air Thin)

Door

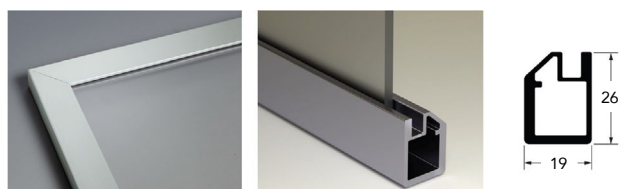

1927

Door Drawer

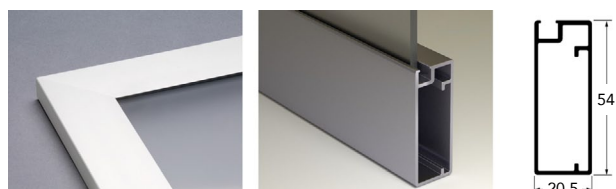

1530 (Air)

Door

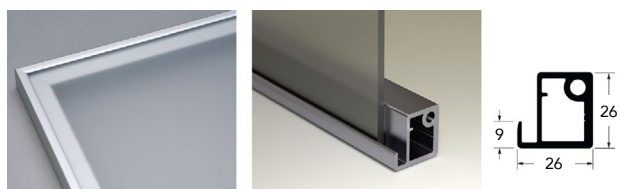

1930

Door

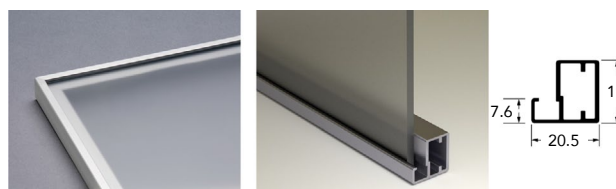

1905

Door

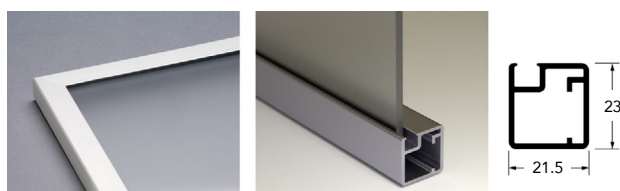

1933

Door

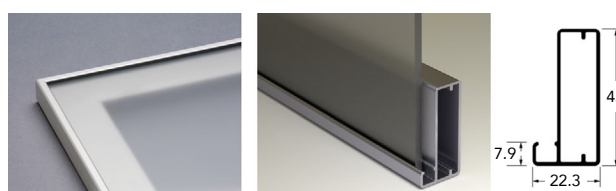

1919

Door Drawer

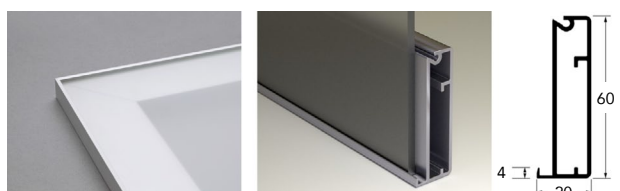

1936

Door Drawer

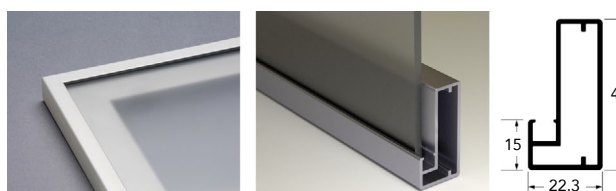

**Frame Profiles** 4mm inserts *continued***EFI**

1939

Door Drawer

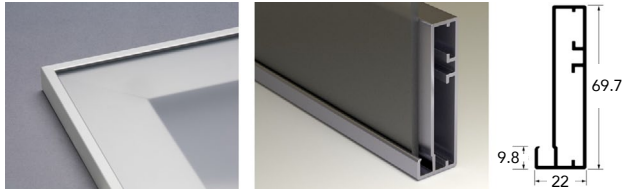

1960

Door Drawer

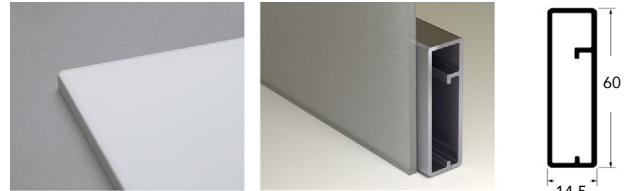

1945

Door Drawer

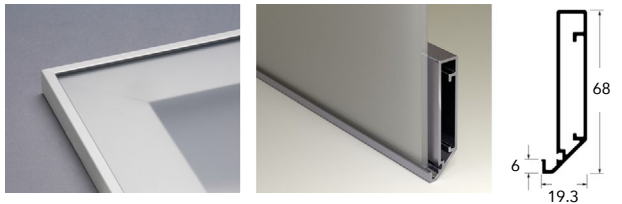

1965

Door Drawer

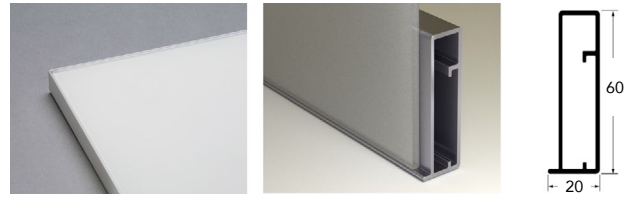

1955

Door

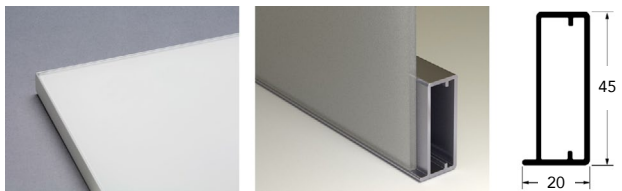
**EFI Base Glass Options** for Aluminum Frames

- All glass is tempered safety glass
- Choose from different glass thicknesses: 4, 6, 10, 12 mm
- Low iron backpainted glass inserts available

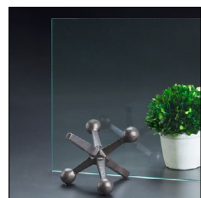
Clear Glass

Clear - Standard

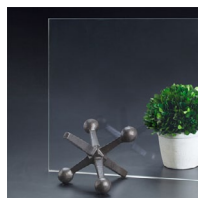

Clear - Low iron

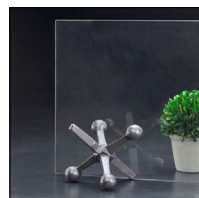

Clear - Grey Tinted



Clear - Bronze Tinted

Pattern Glass

Many choices of Pattern Glass are available.

Barcode
shown vertical

Fabric

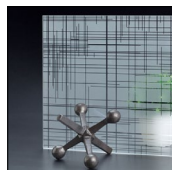

Linen

Colored Glass and Ecoresin Panels

Many choices of Colored Glass and Ecoresin Panels are available.

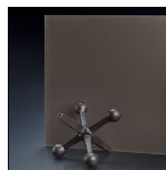
Dark Brown
(2895)

Red (3950)

Panels avail. in 4' x 8'
sheets, cut to size.

Swept Silver

See order form in back of catalog



by States Industries

DRAWERS**WHITE MAPLE APPLE PLY DRAWER SIDES**

Full Cartons Only

- Available in 4 popular heights (1/2" thickness)
- Bullnosed edge
- Prefinished to enhance Maple face veneer
- Clear, durable UV cured finish

8' Lengths
10 each/ctn.
Full Cartons only

Grooved

APPLE PLY QUALITY SELLS:

When people inspect a piece of furniture or cabinetry, the first thing they often do is open a drawer. Real Wood stands out; in a world of vinyl wraps, the demand for real wood products has never been greater. ApplePly sides take screws easily and accept the better quality slides. Clear UV finish on White Maple looks great, stays hard and resists water and household spills.

**BULLNOSE EDGE****9-PLY MAPLE, 1/2" THICKNESS, 8' LENGTH**

10 each/ctn. Full Cartons only

<u>Code</u>	<u>Height</u>	<u>Description</u>	<u>List/ea</u>
AP4M8G	4"	Bullnose, Grooved	\$ 51.42
AP6M8G	6"	" "	73.93
AP8M8G	8"	" "	90.73
AP10M8G	10"	" "	61.75

DRAWER BOTTOM STOCK - 3-PLY MAPLE

Finished on one side only. Full Cartons Only.

<u>Code</u>	<u>Size</u>	<u>Ctn</u>	<u>List/ea</u>
AP44M3	1/4" x 4' x 4'	7 pcs.	\$ 50.40

DRAWERS: Pre-Assembled & Machined for Quadro, Grass, Enterprise and Salice Slides.



Materials: Solid Maple, Melamine, Maple 9-ply prefinished and unfinished, 7-ply prefinished Maple, MDF and more.

Construction: Dovetail, Butt Joint or Dowelled.

Customer Specs: Boxes guaranteed to size within 1/32" width, 1/16" height and 1/8" depth. All dimensions are O.D.

Fax Orders to: 415-552-8577
or Email: orders@macmurraypacific.com

See the following pages for Drawer Box Order Forms:

Cimarron Drawers (pg 1428)

California Drawers (pg 1429)

California Dovetail (pg 1430)

Drawer Box Specialties (pg 1431)

Western Dovetail (back of catalog)

CIMARRON



CIMARRON DRAWER

MACMURRAY
PACIFIC —

568 7th Street, San Francisco, CA 94103



Contact Us: orders@macmurraypacific.com

Tel (415) 552-5500 / Fx (415) 552-5840

FORKLIFT AVAILABLE: Yes ☐ No ☐

Someone ALWAYS there for Deliveries? Yes ☐ No ☐



SHIPPING to COMMERCIAL AREA ☐SHIPPING to RESIDENTIAL AREA ☐







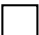

DRAWER SIDE THICKNESS		
3/4"	5/8"	1/2"
		

DRAWER SIDE MATERIAL

DRAWER BOTTOM THICKNESS			
1/4"	<input type="checkbox"/>	1/2"	<input type="checkbox"/>

DRAWER BOTTOM MATERIAL

DRAWER BOTTOM PLACEMENT		
	1/2" (STANDARD)	
	1/4"	
	FLUSH	

OPTIONS			
	ASSEMBLED	FRONT & BACK 1/8" HIGHER THAN SIDES	
	UNASSEMBLED		
	FINISHED		
	UNFINISHED		
	NOTCH FOR UNDERMOUNT SLIDES		
	ATTACH CLIPS - Brand:		
	SCOOP FACE	DOVETAIL	
	PRE-DRILL SUB-FACE	DOWEL	

QUOTE/ORDER FORM

DATE: _____

NAME: _____

ADDRESS: _____

CONTACT: _____ TEL: _____

EMAIL: _____ FAX: _____

QUOTE ORDER Sales Rep _____



P.O.#

****Note PULLOUT drawers in SPECIAL INSTRUCTIONS column****

[illegible]

SPECIAL INSTRUCTIONS:

☐ Order

☐ Quote

**MacMURRAY
PACIFIC**

Order Date _____

Date Due _____

PO No. _____

MacMurray Pacific

568 7th St. SF, CA 94103

Phone: 415-552-5500

Fax: 415-552-5840

Email: orders@macmurraypacific.com

Company:				
Street:				
City:				
State:		Zip:		
Tel:		Fax:		
Contact:				
	W	D	H	Qty
1				
2				
3				
4				
5				
6				
7				
8				
9				
10				
11				

Material Thickness

Edge Preference

1/2"	<input type="radio"/>	1/8" Round Over	<input type="radio"/>
5/8"	<input type="radio"/>	Eased Edges	<input type="radio"/>

Side Material

Solid Maple	<input type="radio"/>	9 Ply Russian Birch	<input type="radio"/>
Other	<input type="radio"/>		

Bottom Thickness

Bottom Material

1/4	<input type="radio"/>	Maple Ply	<input type="radio"/>
1/2	<input type="radio"/>	Melamine	<input type="radio"/>
		Other	<input type="radio"/>

Slides

Corners

Side/No Notch	<input type="checkbox"/>	Dovetailed	<input type="radio"/>
Grass DynaPro	<input type="checkbox"/>	Butt Joint	<input type="radio"/>
Actro 5D	<input type="checkbox"/>	Nailed	<input type="radio"/>
Quadro IW21	<input type="checkbox"/>		
Salice A7555	<input type="checkbox"/>		
Blum Tandem	<input type="checkbox"/>		

Finish

Yes	<input type="radio"/>
No	<input type="radio"/>

Pull Outs

Scoops

Yes	<input type="radio"/>	Yes	<input type="radio"/>
No	<input type="radio"/>	No	<input type="radio"/>

Provide Clips

Yes	<input type="radio"/>
No	<input type="radio"/>

1/8" Step up Front & Back

Yes	<input type="radio"/>
No	<input type="radio"/>

Special Instructions:

California Drawers warrants the drawer box dimension and materials to be in accordance with your order. We must be notified of any discrepancy within five working days of receipt of your drawer box. No returns will be accepted unless they did not meet the order specifications.

I agree to the California Drawer terms and conditions.

Signature: _____



Customer Account: _____

Company: _____

Street: _____

City: _____ State: _____ Zip: _____

Phone: _____ Fax: _____

Contact: _____

Quantity W D H Cabinet #

Special Instructions:

Order Date: _____

ORDER ☐

Date Due: _____

QUOTE ☐

PO #: _____

MacMurray Pacific
568 7th St. SF, CA 94103
Ph. 415-552-5500
Fx. 415-552-5840
Email: orders@macmurraypacific.com

Standard Specifications:*Top Edge: Flat Top With Eased Edge**Corner: Dovetailed**Bottom Material: 1/4"**(drawers over 30" wide get a center strip)**Bottom Construction: 1/2" Inset***Wood:**Maple: ☐ Cherry: ☐ Walnut: ☐Aspen: ☐ Beech: ☐Birch Plywood(1/2" sides only): ☐**Option:**Scoops ☐Bottom Material: 1/2" ☐Bottom Material: 1/4" ☐Side Material: 5/8" ☐Side Material: 1/2" ☐Unfinished ☐Notch & Drill Back ☐

If so, what brand? _____

Install Front Fixing Clips ☐

If so, what brand? _____

Hettich Quadro 1W21 ☐Hettich Quadro 1W20 ☐Grass DynaPro Install Front Fixing Clip ☐Grass DynaPro Install Rear Tilt Clip ☐**Terms & Conditions:**

California Dovetail Co. warrants the drawer box dimension and materials to be in accordance with your order. We must be notified of any discrepancy within five working days of receipt of your drawer box. No returns will be accepted unless they did not meet the order specifications. Tolerances: width to 1/32", depth to 1/8", and height to 1/8".

All drawers are finished after assembly

Signature: _____

Print Name: _____

Rep Name: _____

To submit your order form, you can:

Email to: orders@macmurraypacific.com**Fax to:** 415-552-5840

